



Ellucian Go - Single Sign-On Login Experience

NOTE: As of November 8 2021, this app will use the Single-Sign On (SSO) login page as shown in the steps below.

Step 1 (iOS)

Open the App Store and search for **Ellucian Go**. Click **Get** and follow the installation steps to install the program. Once installed, click **Open**.

Step 1 (iOS)
Open the App Store and search for **Ellucian Go**.
Click **Get** and follow the installation steps to install the program.
Once installed, click **Open**.

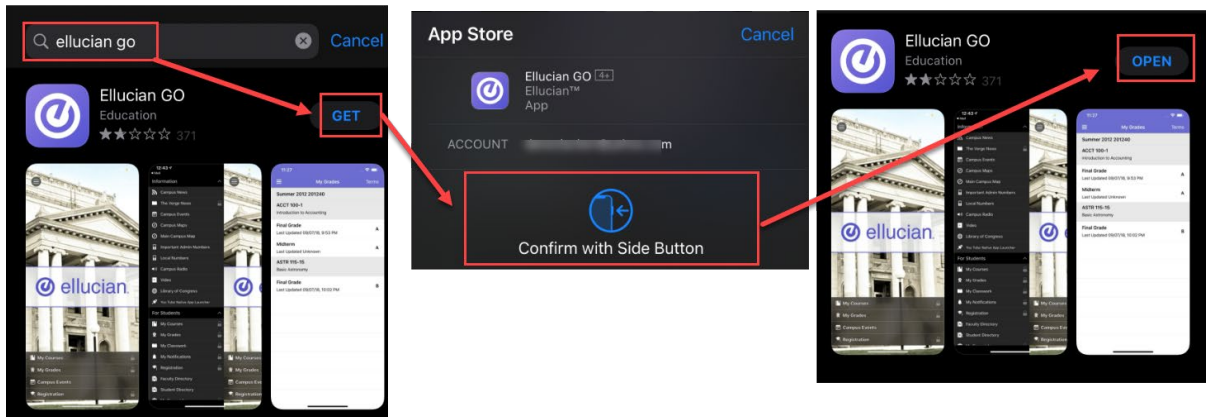

Step 1 (Android)

Open the Google Play Store and search for **Ellucian Go**. Click **Install** and follow the installation steps to install the program. Once installed, click **Open**.

Step 1 (Android)
Open the Google Play Store and search for "Ellucian Go".
Click "Install" and follow the installation steps to install the program.
Once installed, click "Open".

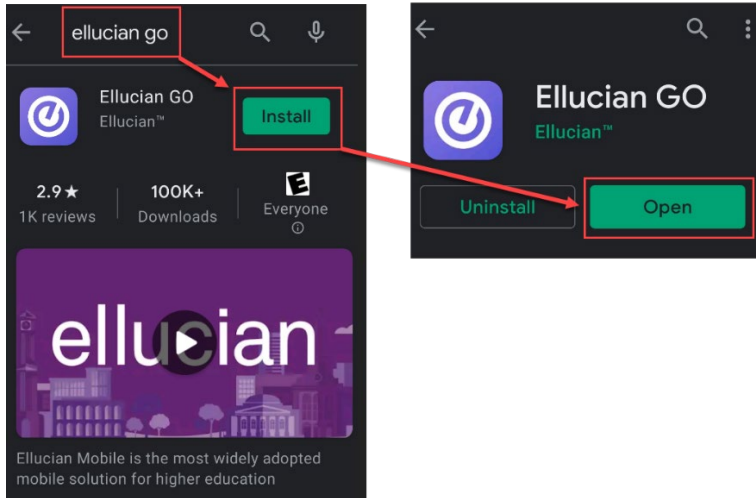

Step 2

When opening the Ellucian Go app for the first time, you will be prompted to **Choose School**.

Tap the **magnifying glass** to bring up the Search Bar.

Search for **RSCCD** to bring up the options for

- **Santa Ana College (SAC)** and
- **Santiago Canyon College (SCC)**.

Select your campus by tapping one of the options.

The screenshot shows the 'Choose School' screen in the Ellucian Go app. The search bar at the top contains the text 'rsccd'. Below the search bar, a list of schools is displayed. The first two schools are highlighted with a red box: 'Santa Ana College (SAC)' and 'Santiago Canyon College (SCC)'. A yellow callout box with a red border is overlaid on the right side of the screen, containing the following text:

Step 2

When opening the Ellucian Go app for the first time, you will be prompted to **Choose School**.

Tap the **magnifying glass** to bring up the Search Bar.

Search for **RSCCD** to bring up the options for **Santa Ana College (SAC)** and **Santiago Canyon College (SCC)**.

Select your campus by tapping one of the options.

Step 3

To login and see your Courses, Registration, Grades, etc -- click the **Menu icon** on the top left corner.

Scroll to the bottom of **Actions** and click **Sign In**.

NOTE: The menu icons with a **Lock icon** next to them indicate you must be signed in before viewing. Clicking these locked options will also take you to the Login page.

Step 3
To login and see your Courses, Registration, Grades, etc -- click the **Menu icon** in the top left corner.
Scroll to the bottom of **Actions** and click **Sign In**.
NOTE: The menu icons with a **Lock icon** next to them indicate you must be signed in before viewing. Clicking these options will also take you to the Login page.

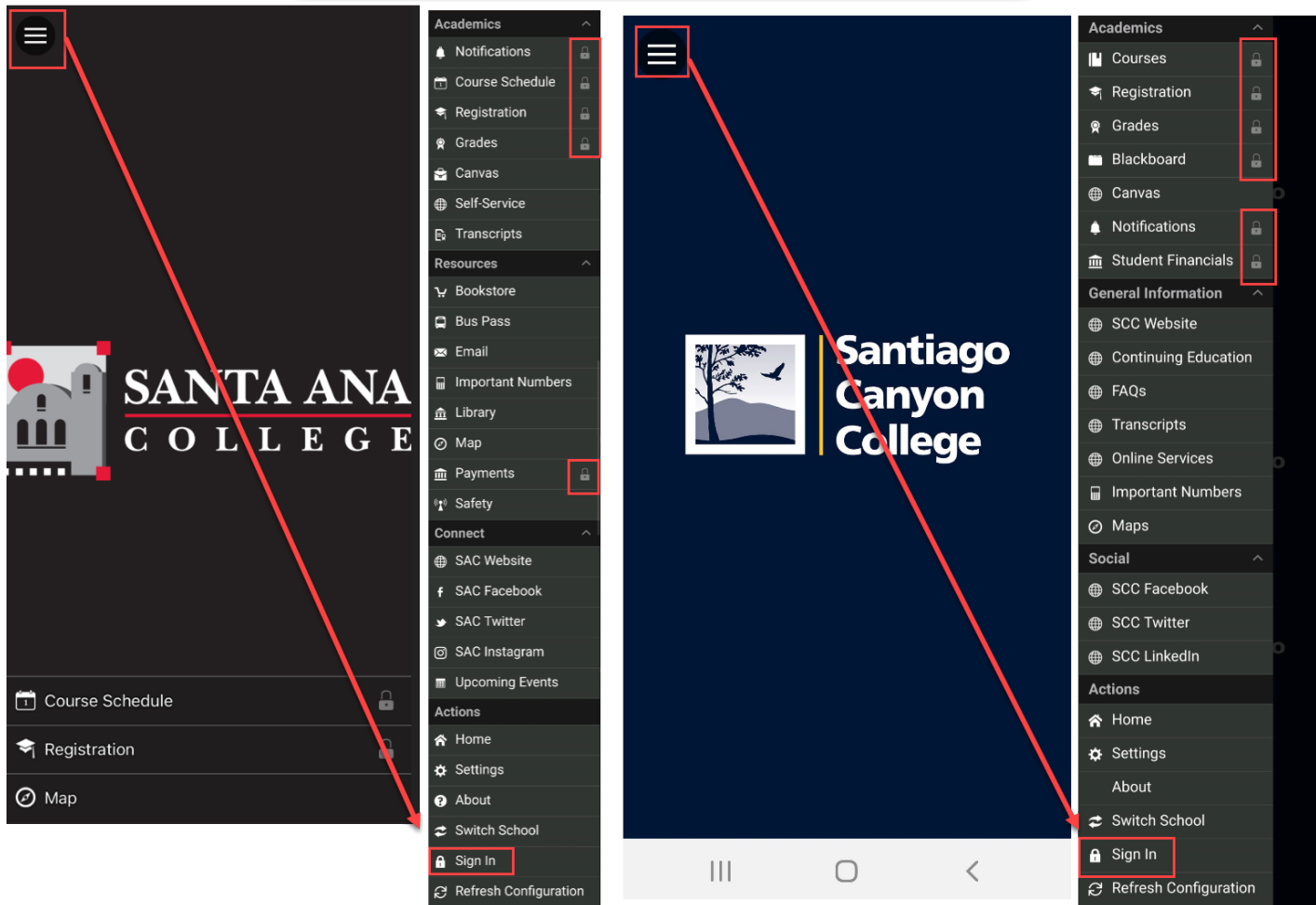

Step 4

You will be redirected to another login page for RSCCD Single-Sign On. Login with your college issued email address and click "Sign In".

Optional: Check the box for "Keep me signed in" to stay signed in.

Username is your college issued email address.

- For Students:
 - WebAdvisorID@student.sac.edu
 - WebAdvisorID@student.scollege.edu
 - Example: ab12345@student.sac.edu
- For Employees:
 - LastName_FirstName@scollege.edu,
 - LastName_FirstName@sac.edu
 - LastName_FirstName@rsccd.edu
 - Example: Smith_John@sac.edu

Default Password is set to your date of birth, in the following format: **MmmDDYYYY**

- 'Mmm' is the first 3 letters of the birth month with a capital first letter.
- 'DD' is the 2-digit birth day.
- 'YYYY' is the 4-digit birth year.

Example: If you were born on December 25 2000 the default password would be Dec252000.

To retrieve your username, or change / reset your password, click "Retrieve Username or Reset Password" or visit www.rsccd.edu/password

The image shows a screenshot of the RSCCD Single Sign-On login page. The page includes logos for Santiago Canyon College and Santa Ana College. The login form has fields for "Sign in with your organizational account" (containing "es03174@student.sac.edu"), "Password", and a "Keep me signed in" checkbox. A "Sign in" button is below the form. Below the form are links for "Single Sign-On FAQs" and "Retrieve Username or Reset Password".

Step 4

You will be redirected to another login page for RSCCD Single Sign-On.

Login with your college issued email address and click "Sign In".

Optional: Check the box for "Keep me signed in" to stay signed in.

Username is your college issued email address.

For Students:
 WebAdvisorID@student.scollege.edu
 WebAdvisorID@student.sac.edu
 Example: ab12345@student.sac.edu

For Employees:
 LastName_FirstName@scollege.edu
 LastName_FirstName@sac.edu
 LastName_FirstName@rsccd.edu
 Example: Smith_John@rsccd.edu

Default Password is set to your date of birth, in the following format: **MmmDDYYYY**

- 'Mmm' is the first 3 letters of the birth month, with a capital first letter.

- 'DD' is the 2 digit birth day.

'YYYY' is the 4 digit birth year.

Example:
 If you were born on December 25 2000 the default password would be Dec252000.

To retrieve your username, or change / reset your password, click "Retrieve Username or Reset Password" or visit www.rsccd.edu/password

Step 5

After logging in, you may be taken to an intermediary page, saying “You are now be redirected back to..”

Tap **POST** to move forward if the page does not redirect you automatically.

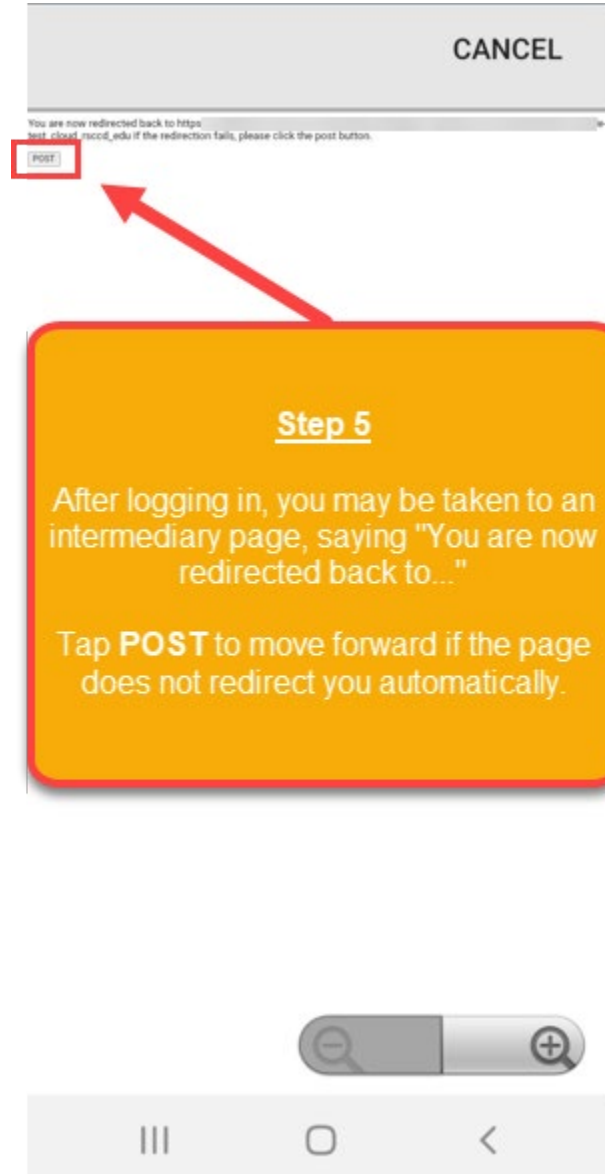

Step 6

Once you are logged in, the Lock icon will disappear from the Menu options, allowing you to access Courses, Registration, Grades, etc.

Step 6
Once you are logged in, the Lock icon will disappear from the Menu options, allowing you to access Courses, Registration, Grades, etc.

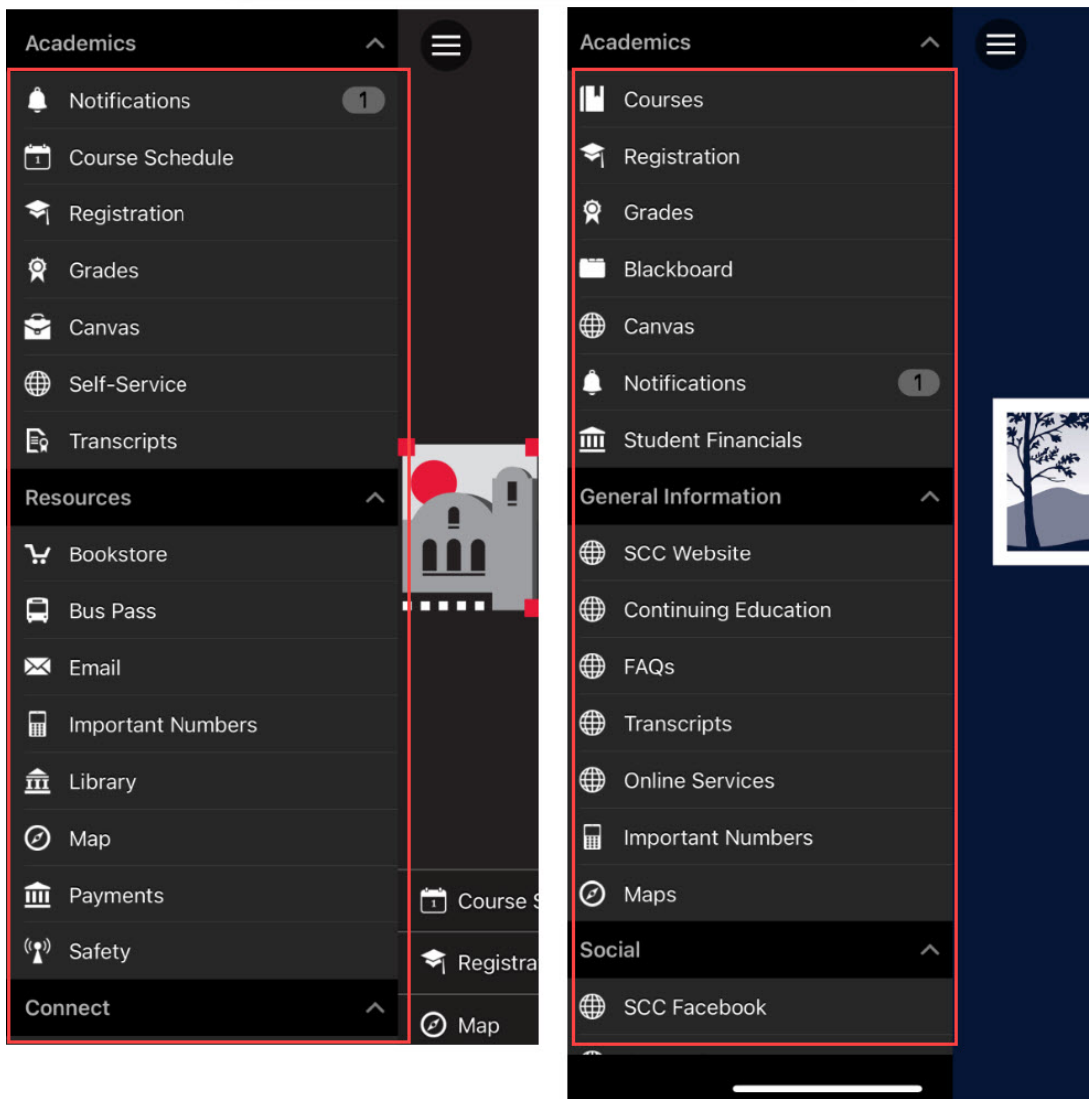

Step 7

To switch Ellucian Go to another campus or institution -- click the **Menu icon** and scroll down to **Switch School**.

This will take you back to the screen in **Step 2** where you can **Choose School**.

Step 7
To switch Ellucian Go to another campus or institution -- click the **Menu icon** and scroll down to **Switch School**.
This will take you back to the screen in **Step 2** where you can **Choose School**.

