

RSCCD FACILITIES MASTER PLAN UPDATES

2022 - 2030

AGENDA

- 01 Status Update
- 02 SAC Proposed Solution Options
- 03 SAC & OCSRTA Preferred Solution
- 04 SAC Preferred Solution Prioritization
- 05 SCC Proposed Solution Options
- 06 SCC Preferred Solution
- 07 SCC Preferred Solution Prioritization

Status Update



WE ARE HERE
Reviewing Preferred
Solutions and Projects
Prioritization

SAC Solution Options / Exploration - Option 1

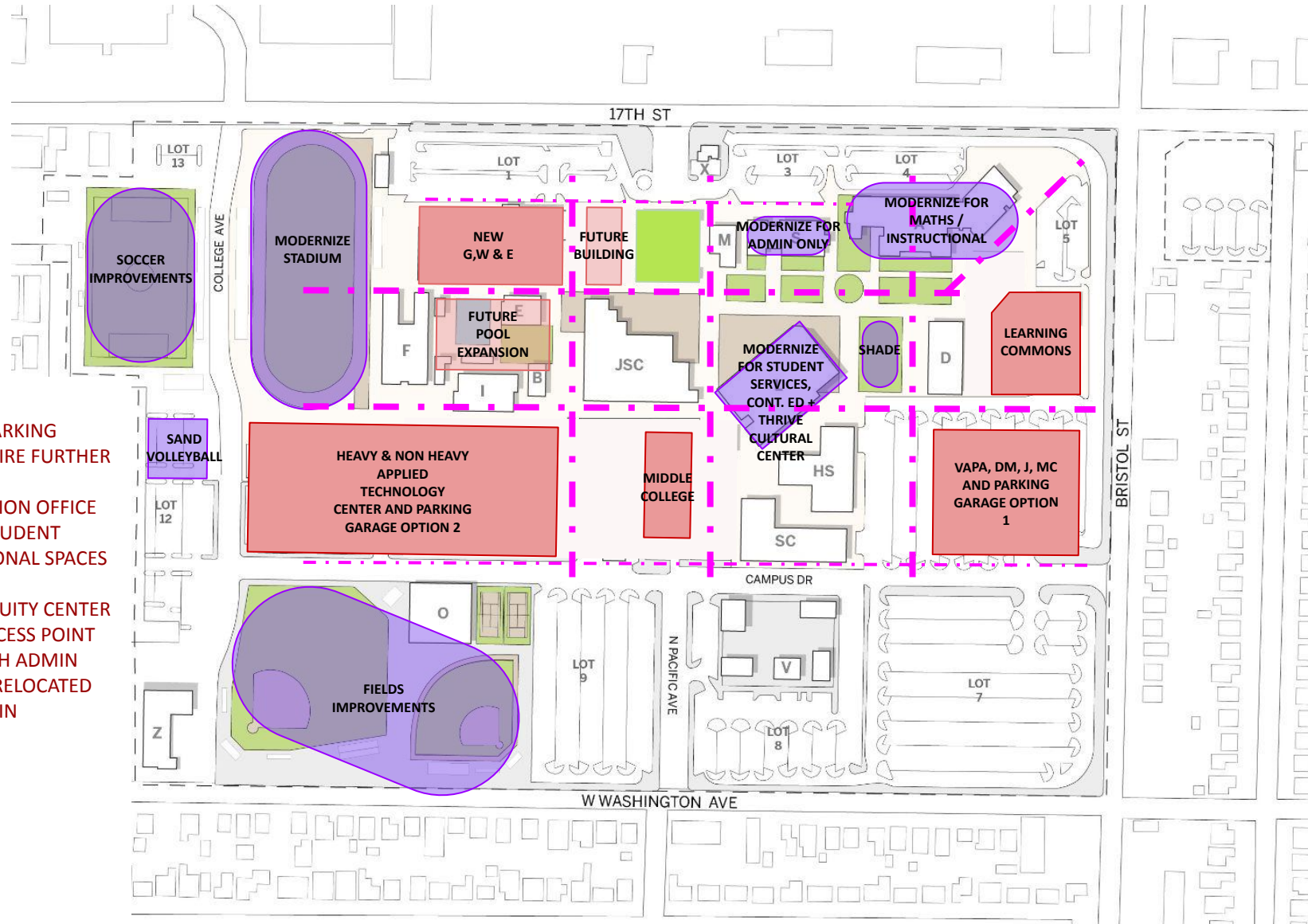

LEGEND

- Building Sites once Demolition occurs
- Area targeted for Entrance/ Drop-off
- Possible Pedestrian Pathways
- New Buildings
- Modernizations
- Future Buildings

CLARIFICATIONS:

- TWO OPTIONS FOR PARKING GARAGES, WILL REQUIRE FURTHER STUDY
- CONTINUING EDUCATION OFFICE COLLOCATED WITH STUDENT SERVICES, INSTRUCTIONAL SPACES TO BE DETERMINED
- THRIVE/CULTURAL EQUITY CENTER TO HAVE ITS OWN ACCESS POINT
- CAMPUS SAFETY WITH ADMIN
- VILLAGE PROGRAMS RELOCATED APPROPRIATELY WITHIN BUILDINGS SHOWN

TO BE DETERMINED:

- DRONE PROGRAM
- DMC

UNDER SEPARATE STUDY:





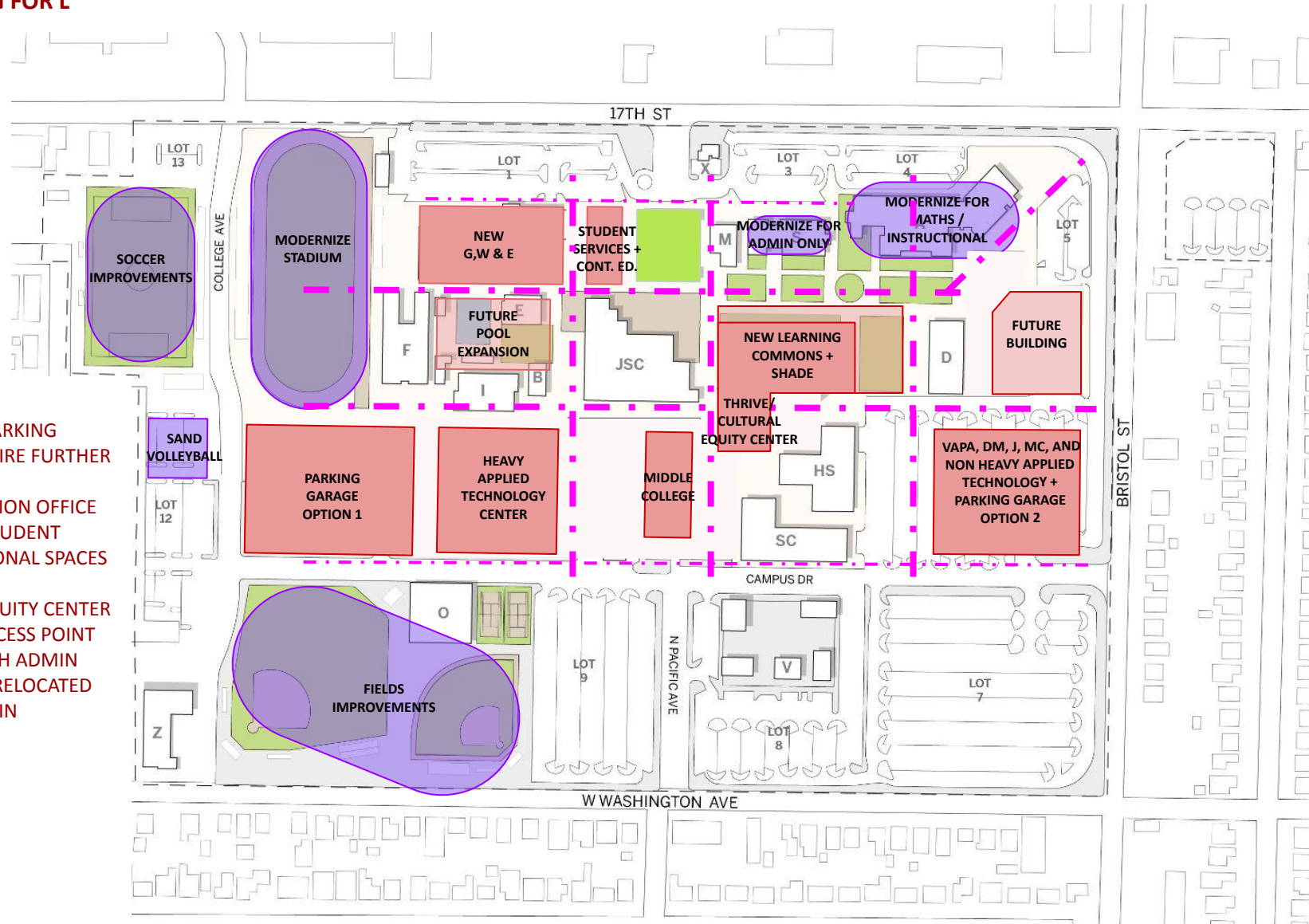

- CEC
- 17TH/BRISTOL
- STUDENT HOUSING

SAC Solution Options / Exploration - Option 2

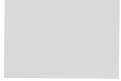
WILL REQUIRE SWING FOR L



LEGEND

-  Building Sites once Demolition occurs
-  Area targeted for Entrance/ Drop-off
-  Possible Pedestrian Pathways
-  New Buildings
-  Modernizations
-  Future Buildings

CLARIFICATIONS:

- TWO OPTIONS FOR PARKING GARAGES, WILL REQUIRE FURTHER STUDY
- CONTINUING EDUCATION OFFICE COLLOCATED WITH STUDENT SERVICES, INSTRUCTIONAL SPACES TO BE DETERMINED
- THRIVE/CULTURAL EQUITY CENTER TO HAVE ITS OWN ACCESS POINT
- CAMPUS SAFETY WITH ADMIN VILLAGE PROGRAMS RELOCATED APPROPRIATELY WITHIN BUILDINGS SHOWN

TO BE DETERMINED:

- DRONE PROGRAM
- DMC

UNDER SEPARATE STUDY:





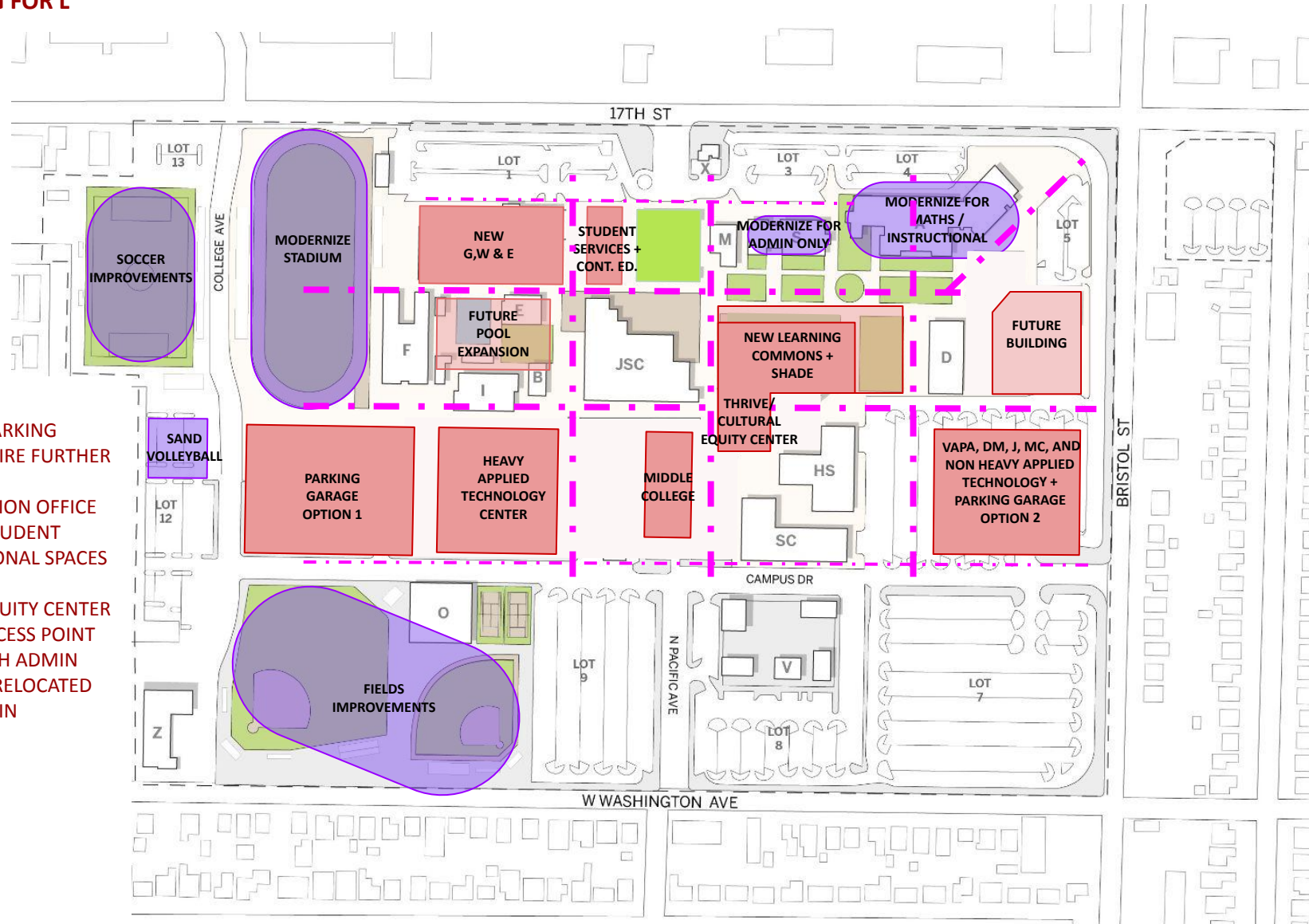

- CEC
- 17TH/BRISTOL
- STUDENT HOUSING

SAC Preferred Solution (Option 2)

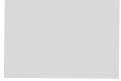
WILL REQUIRE SWING FOR L



LEGEND

-  Building Sites once Demolition occurs
-  Area targeted for Entrance/ Drop-off
-  Possible Pedestrian Pathways
-  New Buildings
-  Modernizations
-  Future Buildings

CLARIFICATIONS:

- TWO OPTIONS FOR PARKING GARAGES, WILL REQUIRE FURTHER STUDY
- CONTINUING EDUCATION OFFICE COLLOCATED WITH STUDENT SERVICES, INSTRUCTIONAL SPACES TO BE DETERMINED
- THRIVE/CULTURAL EQUITY CENTER TO HAVE ITS OWN ACCESS POINT
- CAMPUS SAFETY WITH ADMIN
- VILLAGE PROGRAMS RELOCATED APPROPRIATELY WITHIN BUILDINGS SHOWN

TO BE DETERMINED:

- DRONE PROGRAM
- DMC

UNDER SEPARATE STUDY:

- CEC
- 17TH/BRISTOL
- STUDENT HOUSING

OCSRTA - Proposed/Preferred Solution

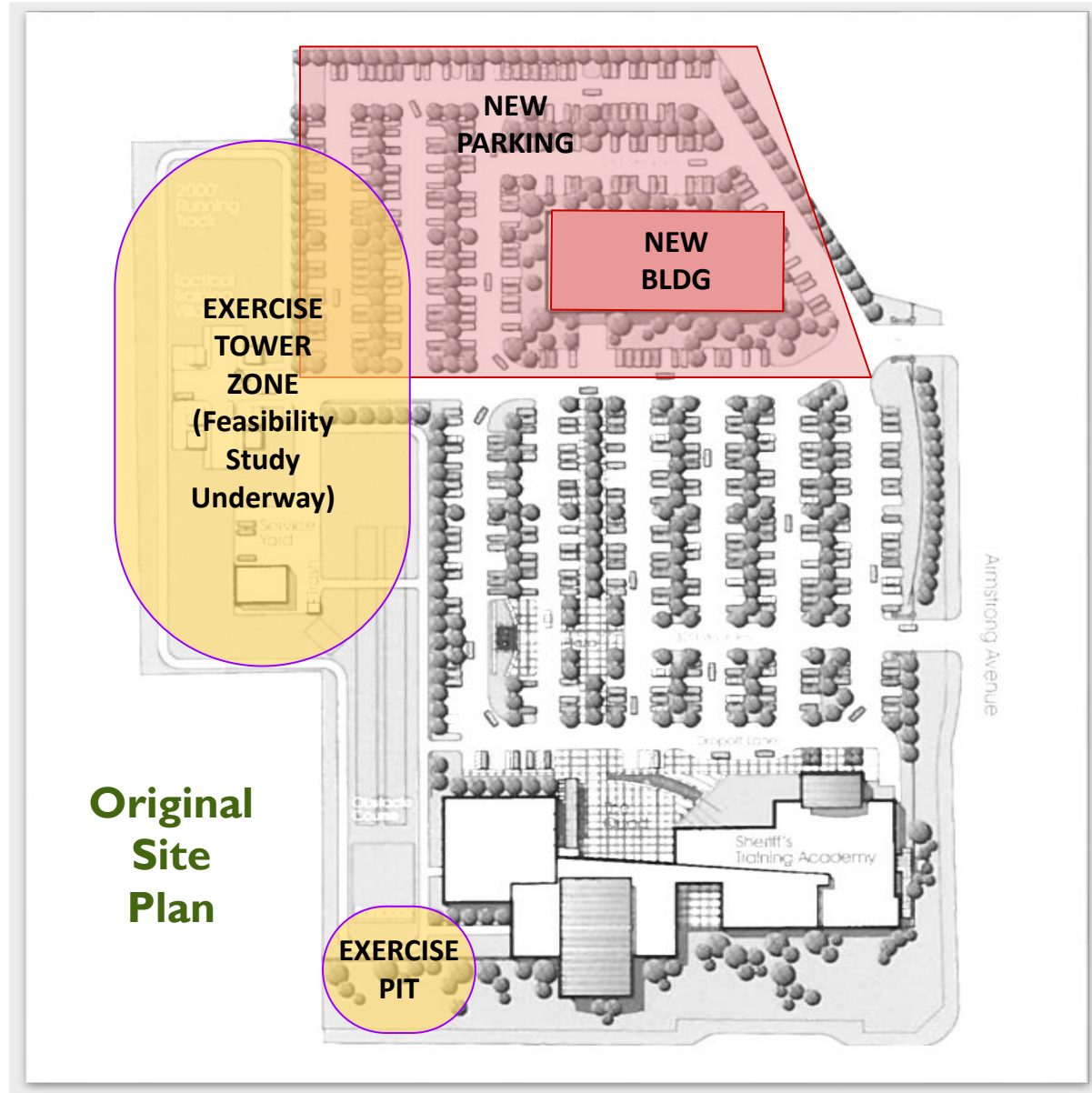

SAC Preferred Solution Prioritization - Page 1 of 2

SAC 2021 FMP UPDATE PROPOSED SOLUTIONS		EDUCATIONAL CRITERIA	FACILITIES CRITERIA	OVERALL SCORE	COMMENTS
		10/19/2021 FSC	11/18/2021 DISTRICT WG	TOTAL COLUMNS TO LEFT	
PROPOSED SOLUTION	PROJECT NEEDS				
NEW (HEAVY DUTY ONLY) APPLIED TECHNOLOGY BUILDING AND PARKING GARAGE	"HEAVY DUTY" APPLIED TECHNOLOGY PROGRAMS: AUTO, DIESEL, WELDING, MANUFACTURING TECHNOLOGY	10	24	34	THE VILLAGE WILL NEED TO SWING
	PARKING/TRAFFIC CIRCULATION IMPROVEMENTS				
NEW VISUAL ARTS, PERFORMING ARTS, MEDIAARTS, FASHION & CULINARY (VAPAMACF) BUILDING AND PARKING GARAGE	PERFORMING ARTS, VISUAL ARTS, DIGITAL MEDIA, JOURNALISM, COMMUNICATIONS	10	24	34	
	"NON HEAVY DUTY" APPLIED TECHNOLOGY PROGRAMS: FASHION, NUTRITION/CULINARY, FIRE TECHNOLOGY				
NEW LEARNING COMMONS (INCLUDES THRIVE / CULTURAL & EQUITY CENTER)	LEARNING COMMONS (LIBRARY, TUTORING & INSTRUCTIONAL SUPPORT CENTER)	9	23	32	PREFERRED OPTION REQUIRES EXISTING L BUILDING OCCUPANTS TO SWING
	THRIVE CENTER / CULTURAL & EQUITY CENTER				
NEW REPLACEMENT CENTENNIAL EDUCATION CENTER (SEE SEPARATE MASTER PLAN STUDY)	CEC	10	20	30	
MODERNIZE BUILDING A (CESAR CHAVEZ) TO COLLOCATE MATHS & INSTRUCTIONAL USE	MATHS CONSOLIDATION (HAMMOND HALL REPLACEMENT)	8	15	23	MIGHT REQUIRE SWING UNLESS PHASED
	OPTIMIZE BUILDING A				
NEW WELCOME CENTER FOR STUDENT SERVICES	OPTIMIZE S BUILDING	2	24	26	

SAC Preferred Solution Prioritization - Page 2 of 2

SAC 2021 FMP UPDATE PROPOSED SOLUTIONS		EDUCATIONAL CRITERIA	FACILITIES CRITERIA	OVERALL SCORE	COMMENTS
		10/19/2021 FSC	11/18/2021 DISTRICT WG	TOTAL COLUMNS TO LEFT	
PROPOSED SOLUTION	PROJECT NEEDS				
NEW REPLACEMENT ATHLETIC GYM FACILITIES (REPLACES G/E/W)	BUILDING G, G PAVILION, W AND E DEFICIENCIES	2	23	25	
MODERNIZE BUILDING S FOR ADMINISTRATION, CEWD AND CAMPUS SECURITY	OPTIMIZE S BUILDING	2	18	20	WILL REQUIRE SWING
	CAMPUS SAFETY/SECURITY FACILITY				
NEW REPLACEMENT MIDDLE COLLEGE HIGH SCHOOL	MIDDLE COLLEGE HIGH SCHOOL	2	15	17	
STADIUM MODERNIZATION	COMPLETE STADIUM FOR COLLEGE USE (INCOMPLETE)	7	9	16	WILL REQUIRE SWING
OCSRTA EXERCISE PIT AND TOWER (feasibility study underway)	OCSRTA FIRE TECHNOLOGY & CRIMINAL JUSTICE	6	7	13	
CAMPUS IMPROVEMENTS PROJECT PHASE 2 AND 3	POST RUSSELL HALL DEMOLITION SECONDARY EFFECTS	2	9	11	
OCSRTA NEW PUBLIC SAFETY FACILITY	OCSRTA FIRE TECHNOLOGY & CRIMINAL JUSTICE	6	5	11	
NEW DRONE EXTERIOR FACILITY REQUIRES SEPARATE STUDY TO DETERMINE LOCATION	DRONE PROGRAM	6	0	6	
BASEBALL AND SOFTBALL FIELDS	BASEBALL AND SOFTBALL FIELD IMPROVEMENTS		5	5	
OUTDOOR AMPHITHEATER UPGRADES (@ DUNLAP HALL)	SHADE AMPHITHEATER AND OTHER CAMPUS SPACES		5	5	
SHADE STRUCTURES AND PLAZA DE ARTES	SHADE AMPHITHEATER AND OTHER CAMPUS SPACES		5	5	
NEW (2) SAND VOLLEYBALL COURTS	SAND VOLLEYBALL	0	4	4	
SOCCER FIELD IMPROVEMENTS	SOCCER FIELD IMPROVEMENTS		4	4	
NEW REPLACEMENT ENLARGED POOL	POOL		8	8	
STUDENT HOUSING SEPARATE STUDY - SEE BELOW	STUDENT HOUSING	7	0	7	
NEW 17TH/BRISTOL PROJECT TO BE DEFINED BY SEPARATE STUDY UNDEWAY	OPTIMIZE USE OF 17TH/BRISTOL SITE	2	0	2	
REPURPOSE DMC TO BE DETERMINED BY SEPARATE STUDY	OPTIMIZE DMC SITE	0	0	0	
IN PROJECTS ABOVE	VILLAGE REPLACEMENT			0	

SCC Solution Options / Exploration - Option 1

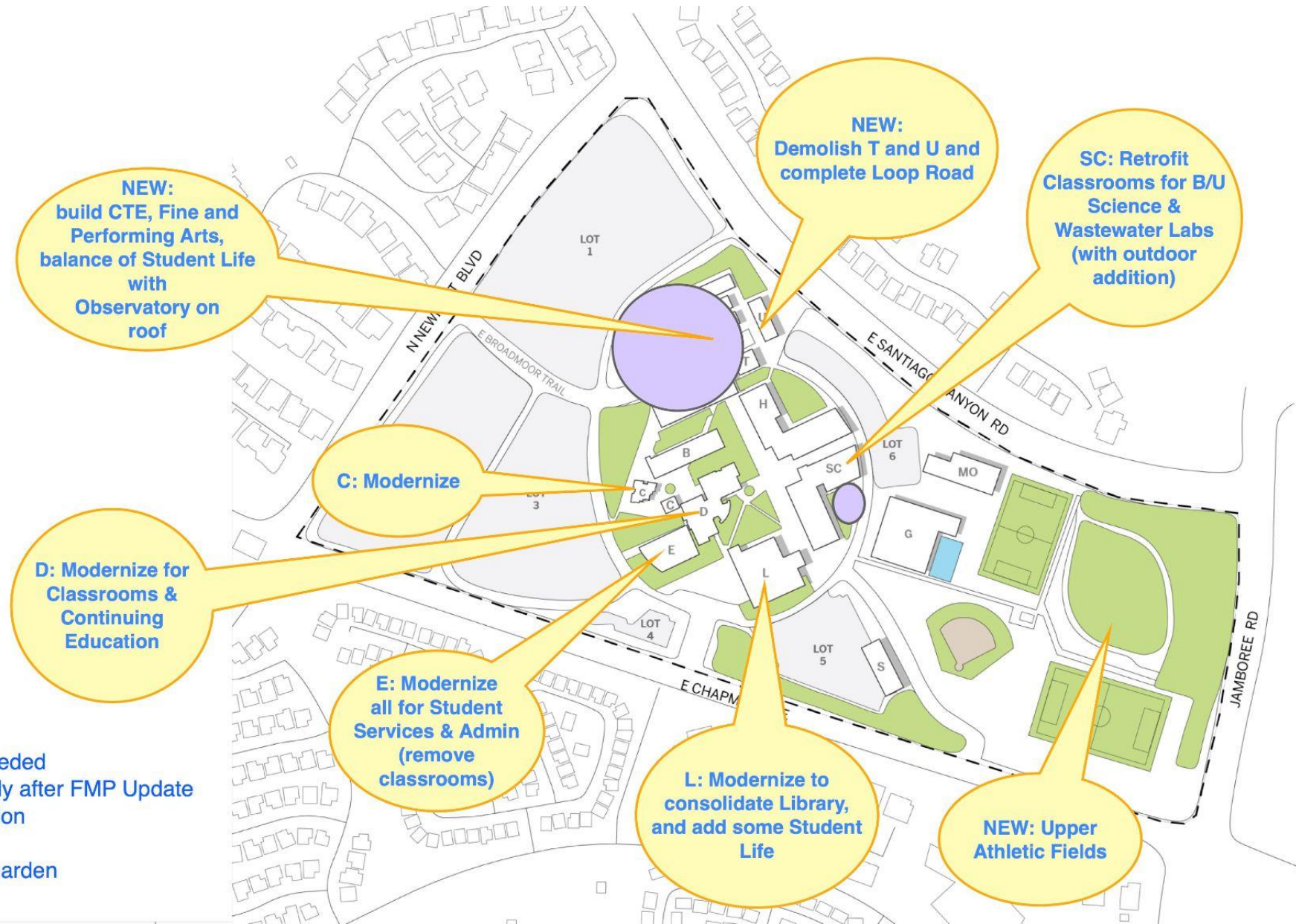

Outstanding:

- Housing - feasibility study needed
- Central Plant - feasibility study after FMP Update
- Horticulture - needs clarification
- Cosmetology
- Coastkeeper Conservation Garden

SCC Solution Options / Exploration - Option 2

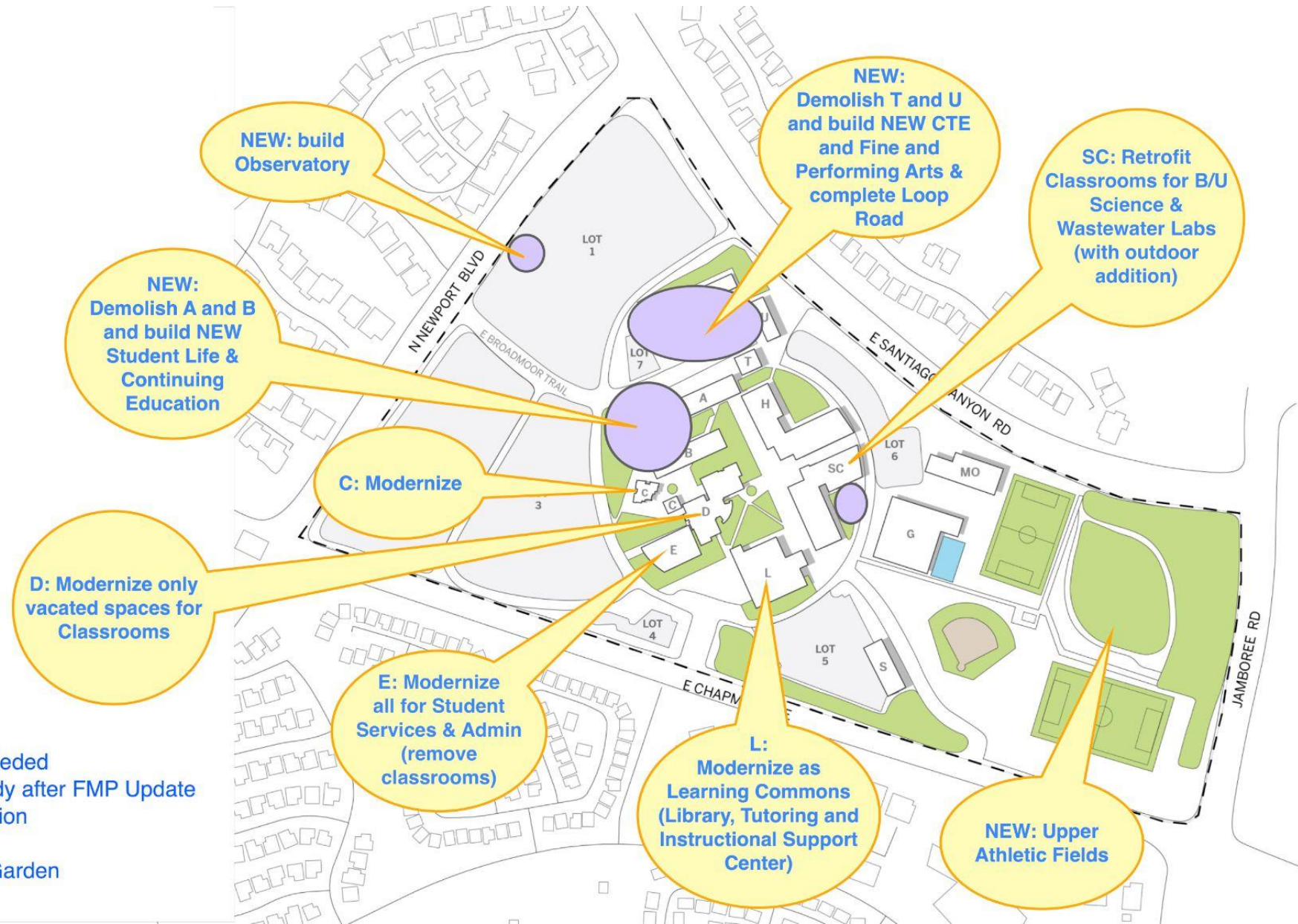

Outstanding:
 Housing - feasibility study needed
 Central Plant - feasibility study after FMP Update
 Horticulture - needs clarification
 Cosmetology
 Coastkeeper Conservation Garden

SCC Preferred Solution (Combination 1 & 2)

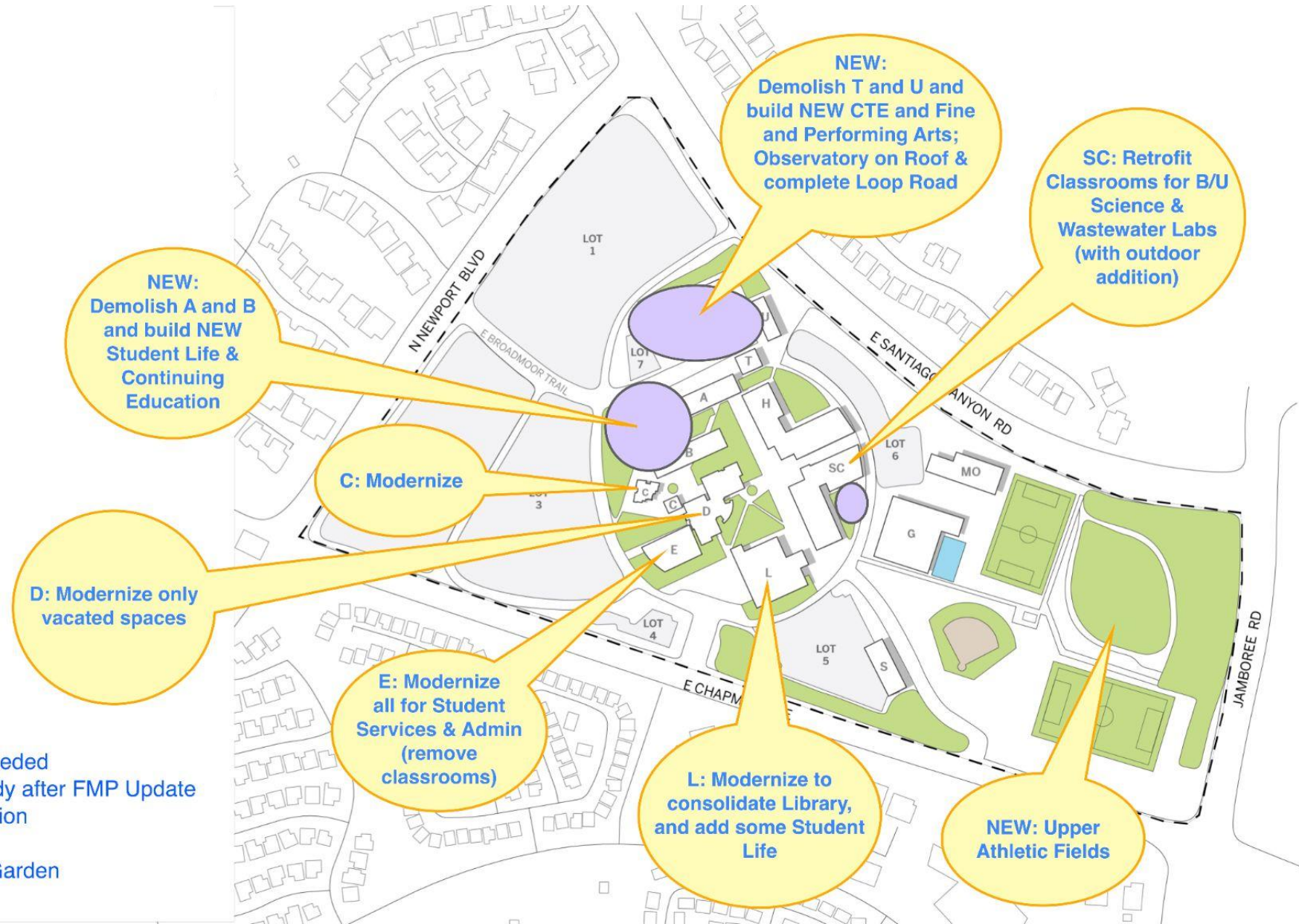

SCC Preferred Solution Prioritization - Page 1 of 2

SCC 2021 FMP UPDATE PROPOSED SOLUTIONS		EDUCATIONAL CRITERIA	FACILITIES CRITERIA	OVERALL SCORE	COMMENTS
		10/04/2021 FSC	11/18/2021 DISTRICT WG	TOTAL COLUMNS TO LEFT	
PROPOSED SOLUTION	PROJECT NEEDS				
MODERNIZE BUILDING E FOR STUDENT SERVICES AND ADMINISTRATION	STUDENT SERVICES	22	13	35	REQUIRED FOR HIGHEST SCORING PROJECT; MIGHT REQUIRE SWING SPACE
	OPTIMIZE BUILDING E	20			
PARTIALLY MODERNIZE BUILDING D FOR INSTRUCTIONAL NEEDS	OPTIMIZE BUILDING D	24	12	36	CAN ONLY OCCUR AFTER PROJECT ABOVE
PARTIAL SCIENCE BUILDING RETROFIT FOR BIOLOGY, CHEMISTRY AND WATER SCIENCE LABS RETROFIT EXISTING CLASSROOMS IN SC BUILDING FOR THESE LABS COMING FROM B AND U BUILDINGS	WASTEWATER LABS	24	9	33	REQUIRED FOR HIGHEST SCORING PROJECT
	SCIENCE LABS (REPLACE B/U AND AUGMENT SC)	20			
PARTIAL L BLDG MODERNIZATION FOR STUDENT LIFE PART A MODERNIZE PARTIAL FIRST FLOOR OF L BUILDING FOR CAFE, CAMPUS STORE AND STUDENT LOUNGE	STUDENT LIFE (FOOD, STUDENT LOUNGE, BOOKSTORE)	20	10	30	HIGHLY DESIRED BY STUDENTS & REQUIRED FOR 2ND HIGHEST SCORING
NEW BUILDING FOR STUDENT LIFE PART B / CONTINUING ED: FOR BALANCE OF STUDENT LIFE / CONTINUING EDUCATION. WOULD INCLUDE TUTORING, SUPPLEMENTAL INSTRUCTION, BASIC NEEDS CENTER, ALONG WITH STUDENT HEALTH, STUDENT GOVERNMENT AND ENGAGEMENT	STUDENT LIFE (HEALTH CENTER, STUDENT GOVERNMENT AND ENGAGEMENT)	20	23	49	HIGHEST SCORING PROJECT NEEDS MOST PROJECTS ABOVE TO CLEAR SITE
	TUTORING	15			
	ACADEMIC COMPUTING	13			
	INSTRUCTIONAL SUPPORT PROGRAMS (LIKE MESA CENTER, UMOJA ETC.)	17			
	CONTINUING ED AT SCC	26			
	BASIC NEEDS CENTER	12			
NEW CAREER & TECHNICAL EDUCATION BUILDING WILL COMBINE BUSINESS, CAREER & TECHNICAL EDUCATION, PERFORMING ARTS, MUSIC, DANCE, COSMETOLOGY, AND OBSERVATORY ON ROOF CTE PROGRAMS INCLUDE: American Sign Language, Apprenticeship, Biotechnology, Business and Computer-Related, Careers in Education, Cinema Studies, Child Development, Code Enforcement Officer, Cosmetology, Criminal Justice, Digital Media Arts, Gemology, Graphic Design, Public Works, Real Estate, Survey/Mapping Sciences, Water Utility Science, Women in Non-Traditional Careers	PERFORMING ARTS, MUSIC, DANCE	24	20	44	2ND HIGHEST SCORING PROJECT NEEDS MOST PROJECTS ABOVE TO CLEAR SITE
	BUSINESS, CAREER & TECHNICAL EDUCATION PROGRAMS	24			
	COSMETOLOGY	22			
	ASTRONOMY (OBSERVATORY)	18			
NEW OEC REPLACEMENT FACILITY	OEC REPLACEMENT	24	14	38	

SAC Preferred Solution Prioritization - Page 2 of 2

SCC 2021 FMP UPDATE PROPOSED SOLUTIONS		EDUCATIONAL CRITERIA	FACILITIES CRITERIA	OVERALL SCORE	COMMENTS
		10/04/2021 FSC	11/18/2021 DISTRICT WG	TOTAL COLUMNS TO LEFT	
PROPOSED SOLUTION	PROJECT NEEDS				
MODERNIZE C BUILDING (CHILD DEVELOPMENT CENTER) PLUS ADDITION FOR CHILD DEVELOPMENT ACADEMIC PROGRAM TO BE CONFIRMED BY CDC LEADERSHIP	CHILD DEVELOPMENT CENTER (C BUILDING)	22	13	35	COULD REQUIRE SWING IF IN SAME LOCATION
	CHILD DEVELOPMENT LABS	16			
NEW UPPER ATHLETIC FIELDS COMPLEX ADD BASEBALL FIELD, TRACK ETC.	UPPER ATHLETIC FIELDS	20	8	28	
EXTERIOR CAMPUS IMPROVEMENTS ENTRY COURT / ROUND ABOUT / CAMPUS QUAD / OUTDOOR CLASSROOM / OUTDOOR GATHERING AREAS MAY NEED TO BE SPLIT INTO SEPARATE	CAMPUS QUAD, ENTRY COURT, SUSTAINABLE LANDSCAPING, OUTDOOR CLASSROOM &	2	13	15	
COMPLETE LOOP ROAD MIGHT BE SEPARATE PROJECT OR FOLDED INTO PROJECT 6 ABOVE	COMPLETE LOOP CIRCLE	0	9	9	
DISCUSSED BUT NOT RESOLVED: REQUIRES FEASIBILITY STUDY	STUDENT HOUSING	0	0	0	
HORTICULTURE / URBAN AGRICULTURE MOST LOGICAL LOCATION IS CLOSE TO NEW CTE BUILDING - COULD BE SEPARATE PROJECT	HORTICULTURE	N/A	0	N/A	
DISCUSSED BUT NOT RESOLVED: REQUIRES STUDY	TECHNOLOGY INFRASTRUCTURE IMPROVEMENTS / UPGRADES	1		N/A	
DISCUSSED BUT NOT RESOLVED: REQUIRES FEASIBILITY STUDY	CENTRAL PLANT & INFRASTRUCTURE	N/A		N/A	
NOT REALLY REQUIRED AT THIS TIME BASED ON FEEDBACK, BUT MAY BE IMPACTED BY STUDENT HOUSING	PARKING	0		N/A	