

RSCCD FACILITIES MASTER PLAN UPDATES

2022 - 2030

AGENDA

- 01 Process & Status Update
- 02 SAC Preferred Solution
- 03 SCC Preferred Solutions
- 04 Other Campus Location Solutions / Updates
- 05 Process to get to Tier One / Tier Two Projects
- 06 SAC Preferred Solution Prioritization Outcome - Tier One / Tier Two
- 07 SCC Preferred Solution Prioritization Outcome - Tier One / Tier Two
- 08 *Some Possible SCC Tier One Sequencing Scenarios*
- 09 *Some Possible SAC Tier One Sequencing Scenarios*
- 10 Next Steps

Decision Making Process for the FMP Update

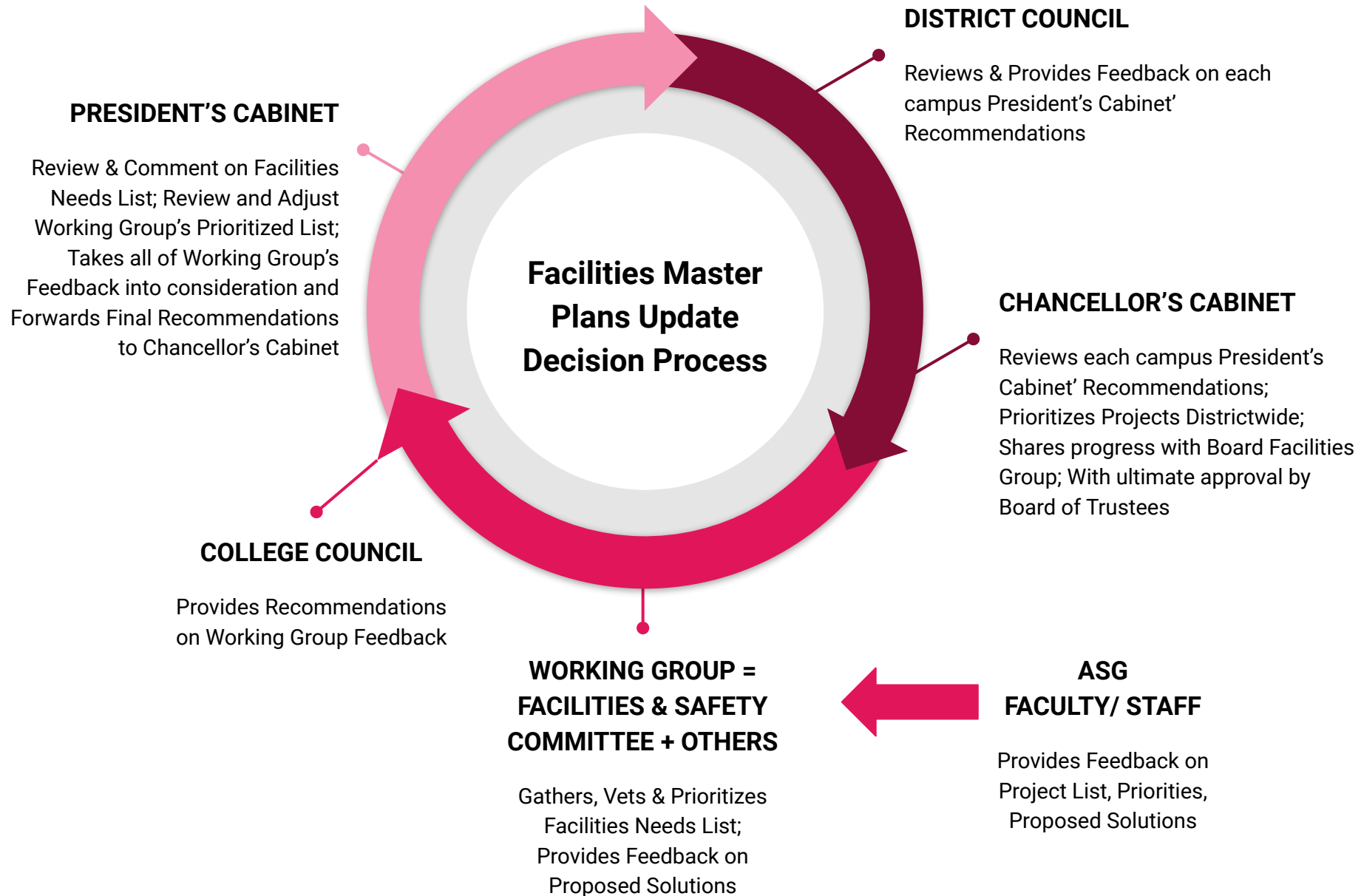

Summary of Intensive Stakeholder Engagement

- Formed three Working Groups
- Completed over 50 meetings to date
- Created Evaluation Criteria (Educational and Facility Conditions)
- Ongoing feedback (via email & meetings with various groups)
- Broader stakeholder feedback outreach effort via weblink & email
- Held two Campus Forums
- Developed and discussed several Projects and Options
- Determined Recommended Campus Options
- Discussed Prioritization of Projects
- Next Steps: Implementation and Sequencing Scenarios, Cost Estimating, Community Campus Forums, Draft and Final Update

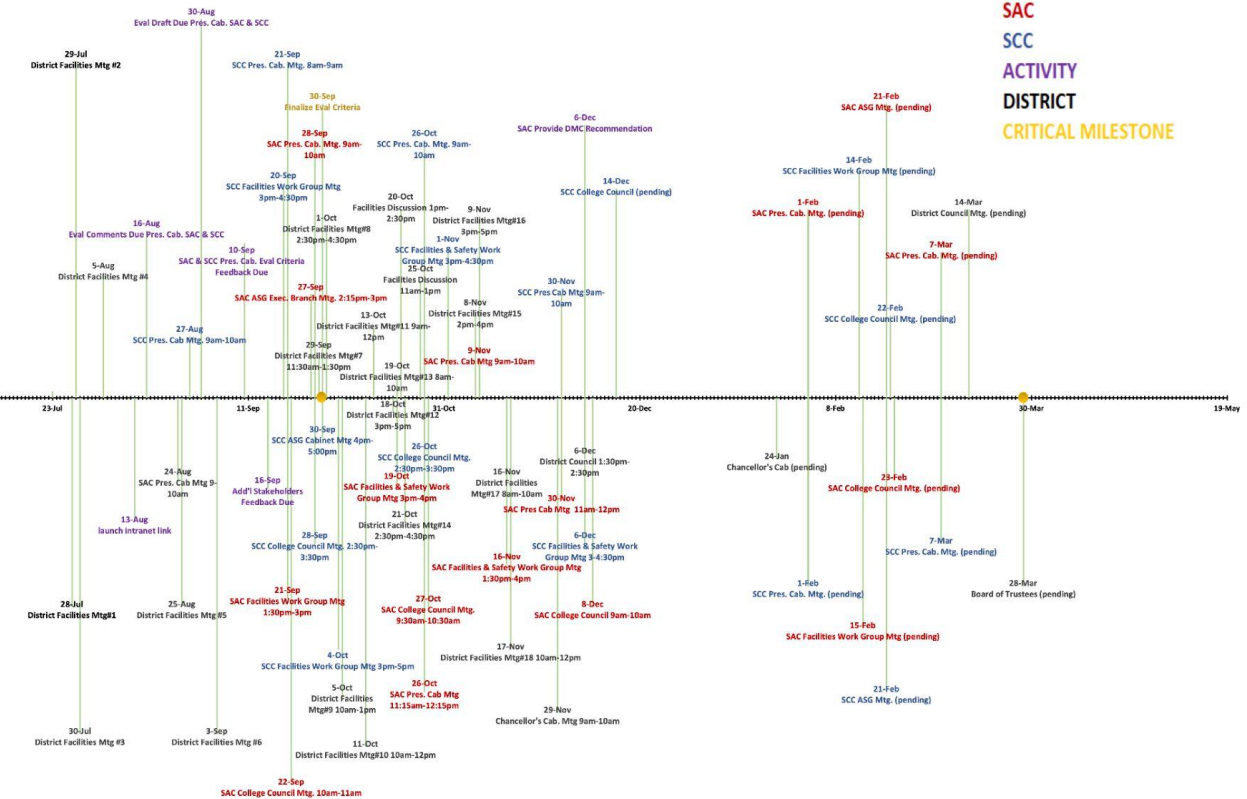

Status Update







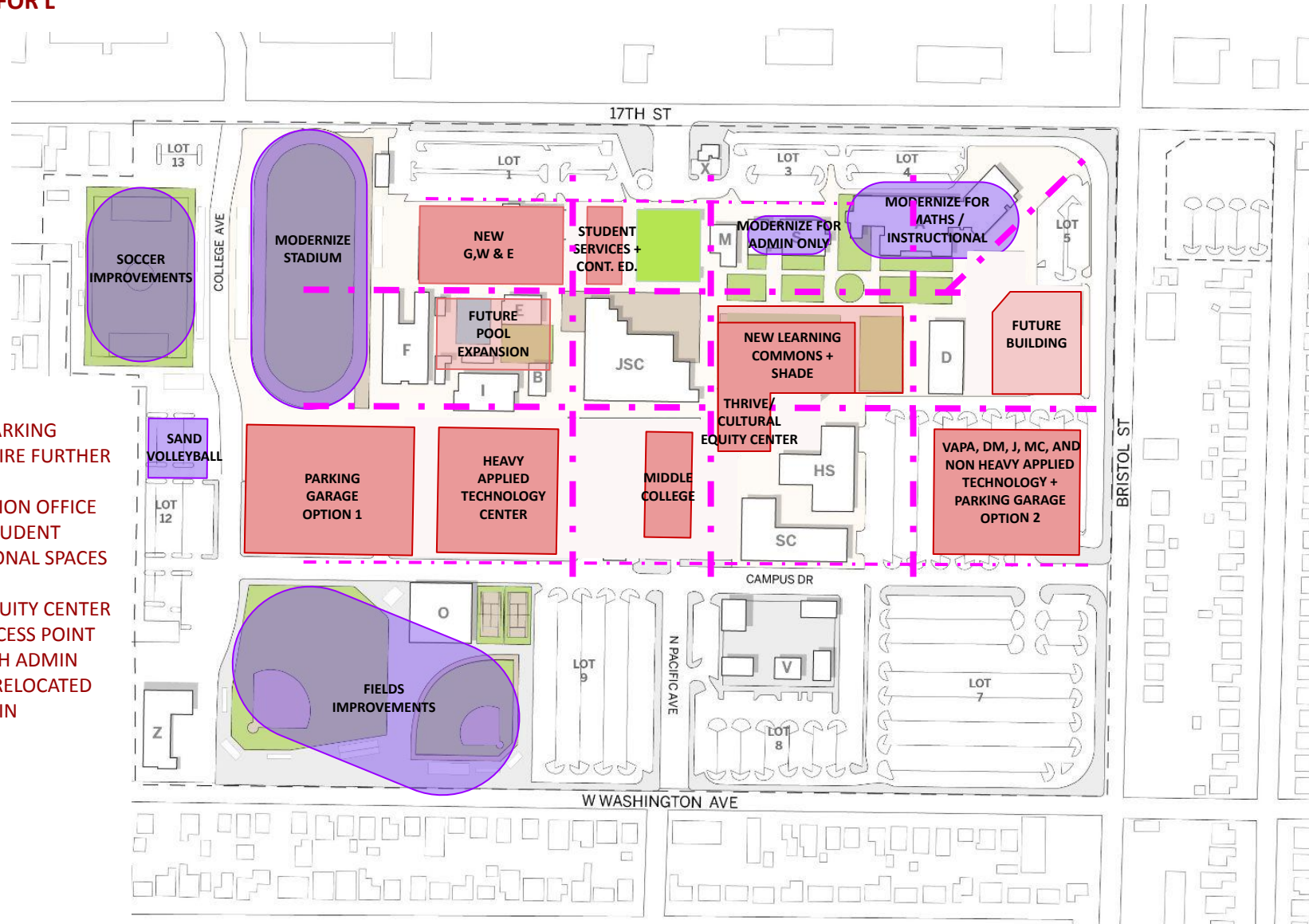

WE ARE HERE
Reviewing Preferred
Solutions and Projects
Prioritization

SAC Preferred Solution (Option 2)

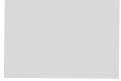
WILL REQUIRE SWING FOR L



LEGEND

-  Building Sites once Demolition occurs
-  Area targeted for Entrance/ Drop-off
-  Possible Pedestrian Pathways
-  New Buildings
-  Modernizations
-  Future Buildings

CLARIFICATIONS:

- TWO OPTIONS FOR PARKING GARAGES, WILL REQUIRE FURTHER STUDY
- CONTINUING EDUCATION OFFICE COLLOCATED WITH STUDENT SERVICES, INSTRUCTIONAL SPACES TO BE DETERMINED
- THRIVE/CULTURAL EQUITY CENTER TO HAVE ITS OWN ACCESS POINT
- CAMPUS SAFETY WITH ADMIN
- VILLAGE PROGRAMS RELOCATED APPROPRIATELY WITHIN BUILDINGS SHOWN

TO BE DETERMINED:

- DRONE PROGRAM
- DMC

UNDER SEPARATE STUDY:

- CEC
- 17TH/BRISTOL
- STUDENT HOUSING

SCC Preferred Solution (Combination 1 & 2) - Alternate One

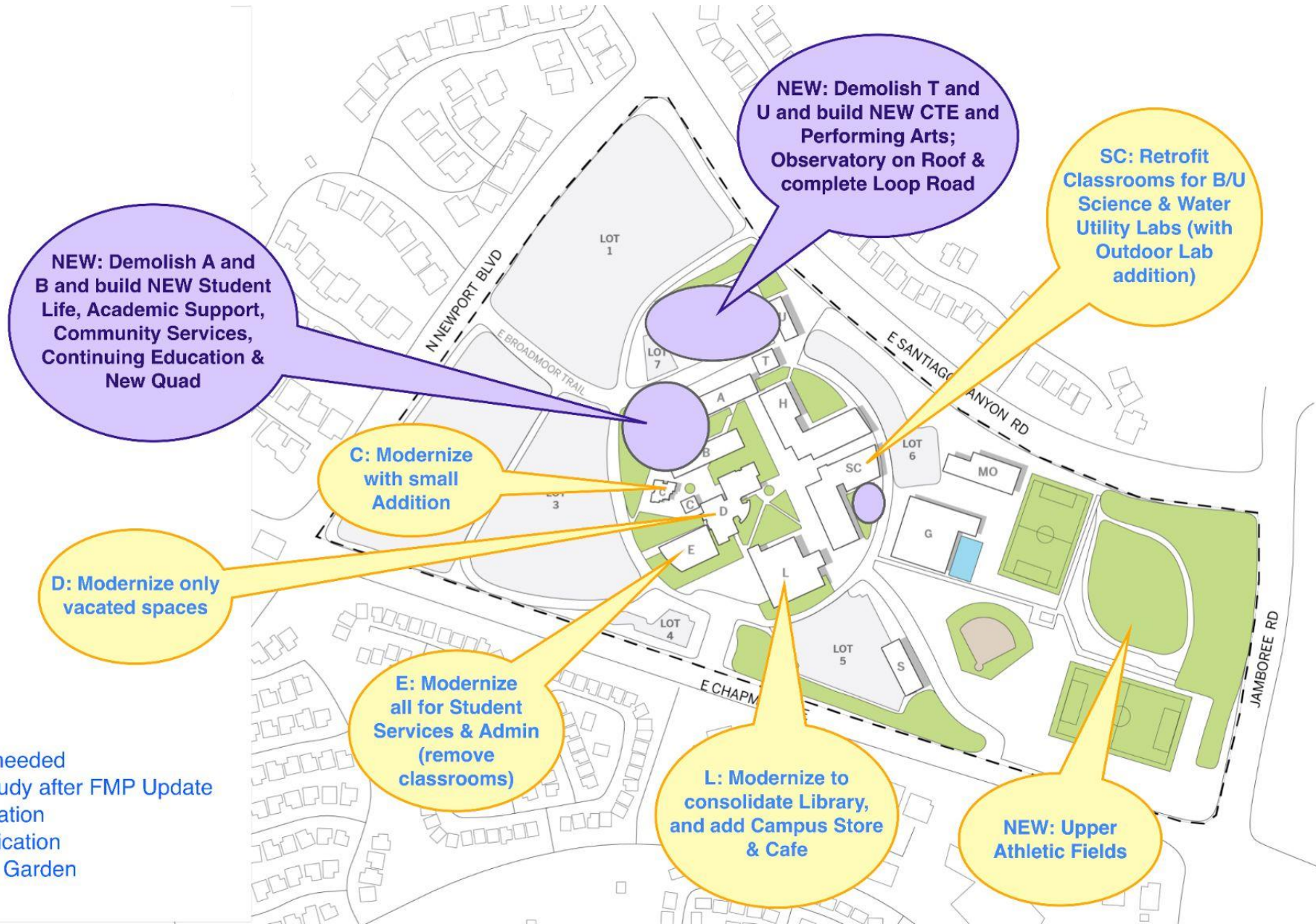

Outstanding:

- Housing - feasibility study needed
- Central Plant - feasibility study after FMP Update
- Horticulture - needs clarification
- Cosmetology - needs clarification
- Coastkeeper Conservation Garden

SCC Preferred Solution (Combination 1 & 2) - Alternate Two

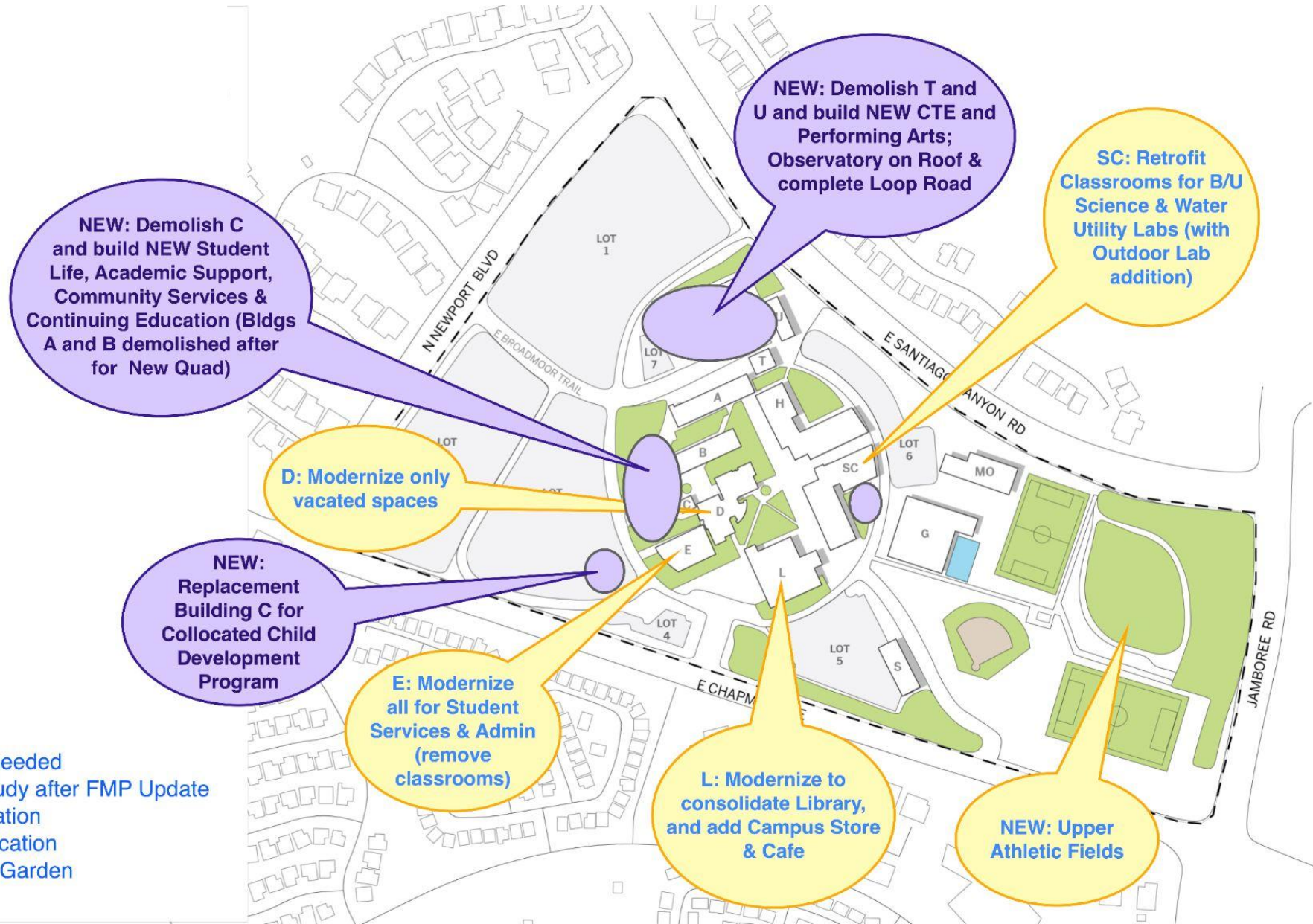

Outstanding:
 Housing - feasibility study needed
 Central Plant - feasibility study after FMP Update
 Horticulture - needs clarification
 Cosmetology - needs clarification
 Coastkeeper Conservation Garden

Other Campus Locations Solutions / Updates:

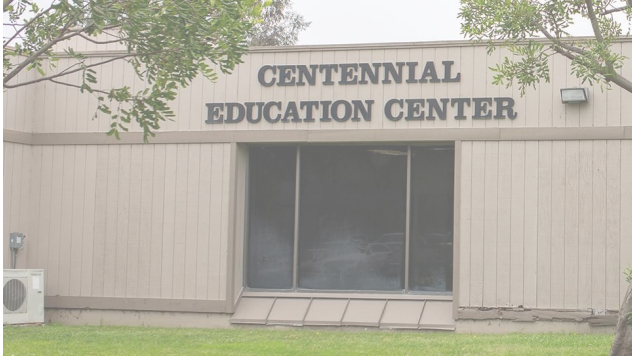

CENTENNIAL EDUCATION CENTER(CEC):
Master Plan Study already underway by Brailsford & Dunlavey / Moore Ruble Yudell Architects



ORANGE EDUCATION CENTER (OEC):
Future Replacement Facility Planning is dependent on outcomes of Environmental Remediation Phase 1 underway

Other Campus Locations Solutions / Updates:

ORANGE COUNTY SHERIFF'S REGIONAL TRAINING ACADEMY

Feasibility Studies underway, and Preferred Solution depicted here

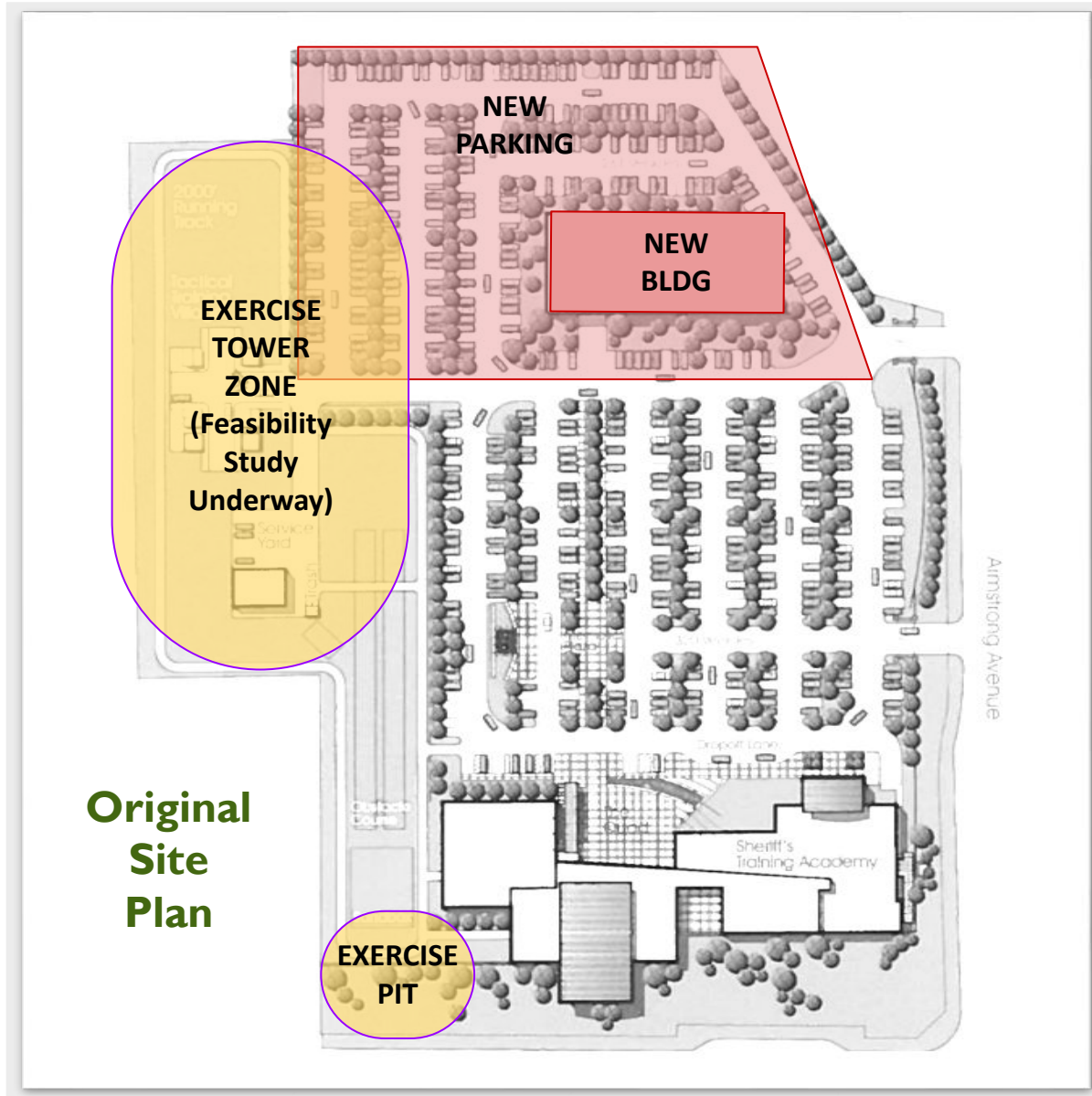

Other Campus Locations Solutions / Updates:

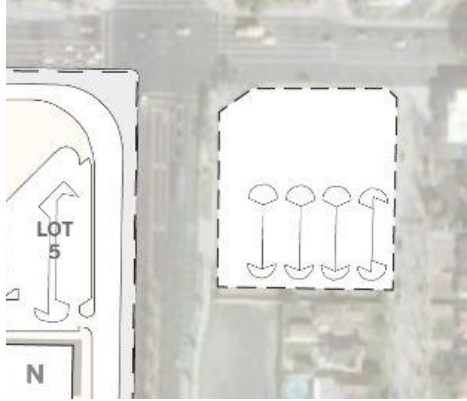

17TH / BRISTOL:

Feasibility Study underway by SVA Architects

DIGITAL MEDIA CENTER (DMC):

As an outcome of this FMP Update process (proposed relocation of existing programs to SAC leaving facility vacant), a feasibility study for best use will be conducted

STUDENT HOUSING AT SAC/SCC:

Feasibility Study awaiting State Grant Funding

Prioritization Process to get to Tier One / Tier Two Projects

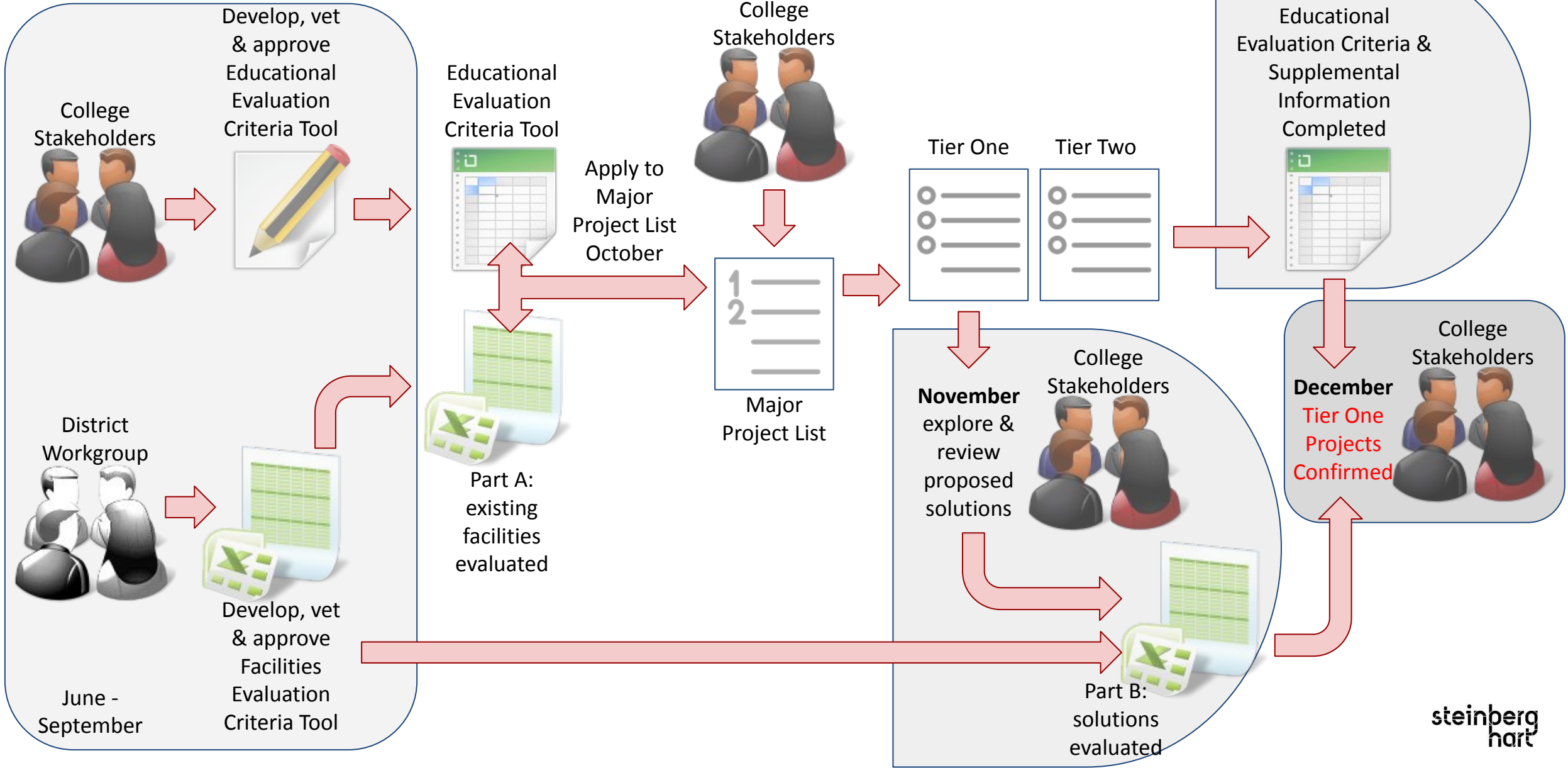

Bear in Mind

Tier One Projects:

- Projects listed under Tier One for each campus encompass the highest scoring projects based on Educational and Facilities Solutions Evaluation Criteria. However, the order that they appear does not reflect the sequence that the projects will be executed. Sequencing will depend on implementation & swing logistics, as well as funding opportunities.
- Naming of Projects may be refined further to be abbreviated etc. FMP Update narrative will describe what programs those projects are expected to address.

Tier Two Projects

- The order they appear does not reflect priority order.
- Projects & Solutions (where applicable) will be identified and part of the FMP Update. However, these projects will not be part of the implementation studies, which will cover the Tier One projects only.

SAC Preferred Solution Prioritization - Tier One

SAC 2021 FMP UPDATE PROPOSED SOLUTIONS			COMMENTS
PROPOSED SOLUTION	ABBREVIATED LABEL	PROJECT NEEDS	
NEW (HEAVY DUTY ONLY) APPLIED TECHNOLOGY BUILDING AND PARKING GARAGE	NEW ATC OR CTE COMPLEX?	"HEAVY DUTY" APPLIED TECHNOLOGY PROGRAMS: AUTO, DIESEL, WELDING, MANUFACTURING TECHNOLOGY PARKING/TRAFFIC CIRCULATION IMPROVEMENTS	THE VILLAGE WILL NEED TO SWING
NEW VISUAL ARTS, PERFORMING ARTS, MEDIAARTS, CULINARY & FASHION (VAPAMACF) BUILDING AND PARKING GARAGE	NEW WORKFORCE DEVELOPMENT COMPLEX?	PERFORMING ARTS, VISUAL ARTS, DIGITAL MEDIA, JOURNALISM, COMMUNICATIONS "NON HEAVY DUTY" APPLIED TECHNOLOGY PROGRAMS: FASHION, NUTRITION/CULINARY, FIRE TECHNOLOGY	
NEW LEARNING COMMONS (INCLUDES THRIVE / CULTURAL & EQUITY CENTER)	NEW LEARNING COMMONS	LEARNING COMMONS (LIBRARY, TUTORING & INSTRUCTIONAL SUPPORT CENTER) THRIVE CENTER / CULTURAL & EQUITY CENTER	PREFERRED OPTION REQUIRES EXISTING L BUILDING OCCUPANTS TO SWING
NEW REPLACEMENT CENTENNIAL EDUCATION CENTER (SEE SEPARATE MASTER PLAN STUDY)	NEW CEC	CEC	
MODERNIZE BUILDING A (CESAR CHAVEZ) TO COLLOCATE MATHS & INSTRUCTIONAL USE	BUILDING A MODERNIZATION	MATHS CONSOLIDATION (HAMMOND HALL REPLACEMENT) OPTIMIZE BUILDING A	MIGHT REQUIRE SWING UNLESS PHASED
NEW WELCOME CENTER FOR STUDENT SERVICES	NEW WELCOME CENTER	OPTIMIZE S BUILDING	NEEDS TO OCCUR AFTER BUILDING A MODERNIZATION

SAC Preferred Solution Prioritization - Tier Two

SAC 2021 FMP UPDATE PROPOSED SOLUTIONS			COMMENTS
PROPOSED SOLUTION	ABBREVIATED LABEL	PROJECT NEEDS	
NEW REPLACEMENT ATHLETIC GYM FACILITIES (REPLACES G/E/W)		BUILDING G, G PAVILION, W AND E DEFICIENCIES	HARD TO SCORE DUE TO LACK OF CLARITY
MODERNIZE BUILDING S FOR ADMINISTRATION, CEWD AND CAMPUS SECURITY		OPTIMIZE S BUILDING	WILL REQUIRE SWING
		CAMPUS SAFETY/SECURITY FACILITY	
NEW REPLACEMENT MIDDLE COLLEGE HIGH SCHOOL		MIDDLE COLLEGE HIGH SCHOOL	
STADIUM MODERNIZATION		COMPLETE STADIUM FOR COLLEGE USE (INCOMPLETE)	WILL REQUIRE SWING
OCSRTA EXERCISE PIT AND TOWER (feasibility study underway)		OCSRTA FIRE TECHNOLOGY & CRIMINAL JUSTICE	
CAMPUS IMPROVEMENTS PROJECT PHASE 2 AND 3		POST RUSSELL HALL DEMOLITION SECONDARY EFFECTS	HARD TO SCORE DUE TO LACK OF CLARITY
OCSRTA NEW PUBLIC SAFETY FACILITY		OCSRTA FIRE TECHNOLOGY & CRIMINAL JUSTICE	
NEW DRONE EXTERIOR FACILITY REQUIRES SEPARATE STUDY TO DETERMINE LOCATION		DRONE PROGRAM	
BASEBALL AND SOFTBALL FIELDS		BASEBALL AND SOFTBALL FIELD IMPROVEMENTS	HARD TO APPLY EDUCATIONAL EVALUATION CRITERIA
OUTDOOR AMPHITHEATER UPGRADES (@ DUNLAP HALL)		SHADE AMPHITHEATER AND OTHER CAMPUS SPACES	HARD TO APPLY EDUCATIONAL EVALUATION CRITERIA
SHADE STRUCTURES AND PLAZA DE ARTES		SHADE AMPHITHEATER AND OTHER CAMPUS SPACES	HARD TO APPLY EDUCATIONAL EVALUATION CRITERIA
NEW (2) SAND VOLLEYBALL COURTS		SAND VOLLEYBALL	HARD TO APPLY EDUCATIONAL EVALUATION CRITERIA
SOCCER FIELD IMPROVEMENTS		SOCCER FIELD IMPROVEMENTS	HARD TO APPLY EDUCATIONAL EVALUATION CRITERIA
NEW REPLACEMENT ENLARGED POOL		POOL	HARD TO APPLY EDUCATIONAL EVALUATION CRITERIA
STUDENT HOUSING SEPARATE STUDY - SEE BELOW		STUDENT HOUSING	HARD TO SCORE DUE TO LACK OF CLARITY
NEW 17TH/BRISTOL PROJECT TO BE DEFINED BY SEPARATE STUDY UNDERWAY		OPTIMIZE USE OF 17TH/BRISTOL SITE	HARD TO SCORE DUE TO LACK OF CLARITY
REPURPOSE DMC TO BE DETERMINED BY SEPARATE STUDY		OPTIMIZE DMC SITE	HARD TO SCORE DUE TO LACK OF CLARITY
IN PROJECTS ABOVE		VILLAGE REPLACEMENT	

SCC Preferred Solution Prioritization - Tier One

SCC 2021 FMP UPDATE PROPOSED SOLUTIONS			COMMENTS
PROPOSED SOLUTION	ABBREVIATED LABEL	PROJECT NEEDS	
NEW BUILDING FOR STUDENT LIFE, ACADEMIC SUPPORT, COMMUNITY SERVICES & CONTINUING EDUCATION STUDENT LIFE INCLUDES STUDENT HEALTH, STUDENT GOVERNMENT, CLUBS AND STUDENT ACTIVITIES; ACADEMIC SUPPORT WOULD INCLUDE TUTORING, SUPPLEMENTAL INSTRUCTION, BASIC NEEDS CENTER; COMMUNITY SERVICES AND CONTINUING EDUCATION	NEW STUDENT AND COMMUNITY COMMONS? OR SLASCC	STUDENT LIFE (HEALTH CENTER, STUDENT GOVERNMENT AND ENGAGEMENT) TUTORING ACADEMIC COMPUTING INSTRUCTIONAL SUPPORT PROGRAMS (LIKE MESA CENTER, UMOJA ETC.) CONTINUING ED AT SCC BASIC NEEDS CENTER	HIGHEST SCORING PROJECT NEEDS MOST PROJECTS BELOW TO CLEAR SITE
NEW CAREER & TECHNICAL EDUCATION BUILDING WILL COMBINE BUSINESS, CAREER & TECHNICAL EDUCATION, PERFORMING ARTS, MUSIC, DANCE, AND OBSERVATORY ON ROOF CTE PROGRAMS MAY INCLUDE: American Sign Language, Apprenticeship, Biotechnology, Business and Computer-Related, Careers in Education, Cinema Studies, Child Development, Code Enforcement Officer, Cosmetology & Barbering, Criminal Justice, Digital Media Arts, Gemology, Graphic Design, Public Works, Real Estate, Survey/Mapping Sciences, Water Utility Science, Women in Non-Traditional Careers and Horticulture	NEW CTE	PERFORMING ARTS, MUSIC, DANCE BUSINESS, CAREER & TECHNICAL EDUCATION PROGRAMS COSMETOLOGY ASTRONOMY (OBSERVATORY)	2ND HIGHEST SCORING PROJECT NEEDS MOST PROJECTS BELOW TO CLEAR SITE
NEW OEC REPLACEMENT FACILITY	NEW OEC	OEC REPLACEMENT	
PARTIALLY MODERNIZE BUILDING D FOR INSTRUCTIONAL NEEDS	D PARTIAL MOD.	OPTIMIZE BUILDING D	CAN ONLY OCCUR AFTER MOST OTHER SCC PROJECTS
MODERNIZE BUILDING E FOR STUDENT SERVICES AND ADMINISTRATION	E MODERNIZATION (SLASCC MAKE READY)	STUDENT SERVICES OPTIMIZE BUILDING E	PROJECT NEEDED FOR SCC CAMPUS PROJECTS ABOVE
PARTIAL SCIENCE BUILDING RETROFIT FOR BIOLOGY, CHEMISTRY AND WATER UTILITY SCIENCE LABS RETROFIT EXISTING CLASSROOMS IN SC BUILDING FOR THESE LABS COMING FROM B AND U BUILDINGS	SCIENCE PARTIAL MOD. (CTE MAKEREADY)	WASTEWATER LABS SCIENCE LABS (REPLACE B/U AND AUGMENT SC)	PROJECT NEEDED FOR PROJECTS ABOVE
PARTIAL L BLDG MODERNIZATION FOR CAMPUS STORE & CAFE MODERNIZE PARTIAL FIRST FLOOR OF L BUILDING FOR CAFE, CAMPUS STORE AND STUDENT LOUNGE	L PARTIAL MOD. (CTE MAKEREADY)	STUDENT LIFE (FOOD, STUDENT LOUNGE, BOOKSTORE)	PROJECT NEEDED FOR SCC CAMPUS PROJECTS ABOVE
MODERNIZE C BUILDING (CHILD DEVELOPMENT CENTER) PLUS SMALL ADDITION FOR CHILD DEVELOPMENT ACADEMIC PROGRAM OR REPLACE C BUILDING & COLLOCATE PROGRAM	C MOD OR NEW CDC	CHILD DEVELOPMENT CENTER (C BUILDING) CHILD DEVELOPMENT LABS	COULD REQUIRE SWING IF IN SAME LOCATION

SCC Preferred Solution Prioritization - Tier Two

SCC 2021 FMP UPDATE PROPOSED SOLUTIONS			COMMENTS
PROPOSED SOLUTION	ABBREVIATED LABEL	PROJECT NEEDS	
NEW UPPER ATHLETIC FIELDS COMPLEX ADD BASEBALL FIELD, TRACK ETC.		UPPER ATHLETIC FIELDS	
EXTERIOR CAMPUS IMPROVEMENTS ENTRY COURT / ROUND ABOUT / CAMPUS QUAD / OUTDOOR CLASSROOM / OUTDOOR GATHERING AREAS MAY NEED TO BE SPLIT INTO SEPARATE PROJECTS OR COMBINED WITH OTHERS BASED ON CURRENT SITING		CAMPUS QUAD, ENTRY COURT, SUSTAINABLE LANDSCAPING, OUTDOOR CLASSROOM & GATHERING AREAS	
COMPLETE LOOP ROAD MIGHT BE SEPARATE PROJECT OR FOLDED INTO ANOTHER PROJECT		COMPLETE LOOP CIRCLE	
DISCUSSED BUT NOT RESOLVED: REQUIRES FEASIBILITY STUDY		STUDENT HOUSING	
HORTICULTURE / URBAN AGRICULTURE MOST LOGICAL LOCATION IS CLOSE TO NEW CTE BUILDING - COULD BE SEPARATE PROJECT		HORTICULTURE	
DISCUSSED BUT NOT RESOLVED: REQUIRES STUDY		TECHNOLOGY INFRASTRUCTURE IMPROVEMENTS / UPGRADES	
DISCUSSED BUT NOT RESOLVED: REQUIRES FEASIBILITY STUDY		CENTRAL PLANT & INFRASTRUCTURE	
NOT REALLY REQUIRED AT THIS TIME BASED ON FEEDBACK, BUT MAY BE IMPACTED BY STUDENT HOUSING		PARKING	

Some Possible Sequencing Scenarios for SCC Campus Projects

Final Scenario will depend on available funding resources and implementation/swing logistics

Scenario One

L Partial Modernization
Science Partial Modernization
Balance of U Swing (TBD)
New CTE Building

E Modernization
D Partial Modernization
New Student & Community
Commons Building

CDC Modernization/Addition

Scenario Two

L Partial Modernization
Science Partial Modernization
Balance of U Swing (TBD)
New CTE Building

New CDC
New Student & Community
Commons Building

E Modernization
D Partial Modernization

Scenario Three

New CDC
New Student & Community
Commons Building*

Science Modernization
Balance of U Swing (TBD)
New CTE Building

E Modernization
D Partial Modernization

* Would include Campus Store & Cafe so the L Partial Mod would no longer be required

Some Possible Sequencing Scenarios for SAC Campus Projects

Final Scenario will depend on available funding resources and implementation/swing logistics

Scenario One

New Workforce Development
(with Parking Garage)

*Learning Commons Swing (in C,
N and P)*

New Learning Commons

New Applied Technology Center
(possibly with Parking Garage)

Modernize Building A

New Welcome Center

Scenario Two

Village Swing

New Applied Technology Center
(with Parking Garage)

New Workforce Development
(possibly with Parking Garage)

*Learning Commons Swing (in C,
N and P)*

New Learning Commons

Modernize Building A

New Welcome Center

Scenario Three

Learning Commons Swing (tbd)

New Learning Commons

New Applied Technology Center
(with Parking Garage)

New Workforce Development
(possibly with Parking Garage)

Modernize Building A

New Welcome Center

Next Steps

- Refinement of Project Names (now through February 2022)
- Explore Implementation and Sequencing Scenarios
- Create Conceptual Cost Estimates for Tier One Projects
- Creation of Draft FMP Update Document (December - January)
- Review of Draft FMP Update Document in February 2022
- Community Campus Forums on Draft FMP Update
- Finalize FMP Update