

RSCCD FACILITIES MASTER PLAN UPDATES

2022 - 2030

AGENDA

- 01 Status Update
- 02 SAC Preferred Solution
- 03 Other Campus Location Solutions / Updates
- 04 Prioritization Process Status
- 05 Supplemental Information
- 06 SAC Preferred Solution Prioritization Outcome - Tier One / Tier Two
- 07 *Some Possible SAC Tier One Sequencing Scenarios*
- 08 Next Steps

Status Update







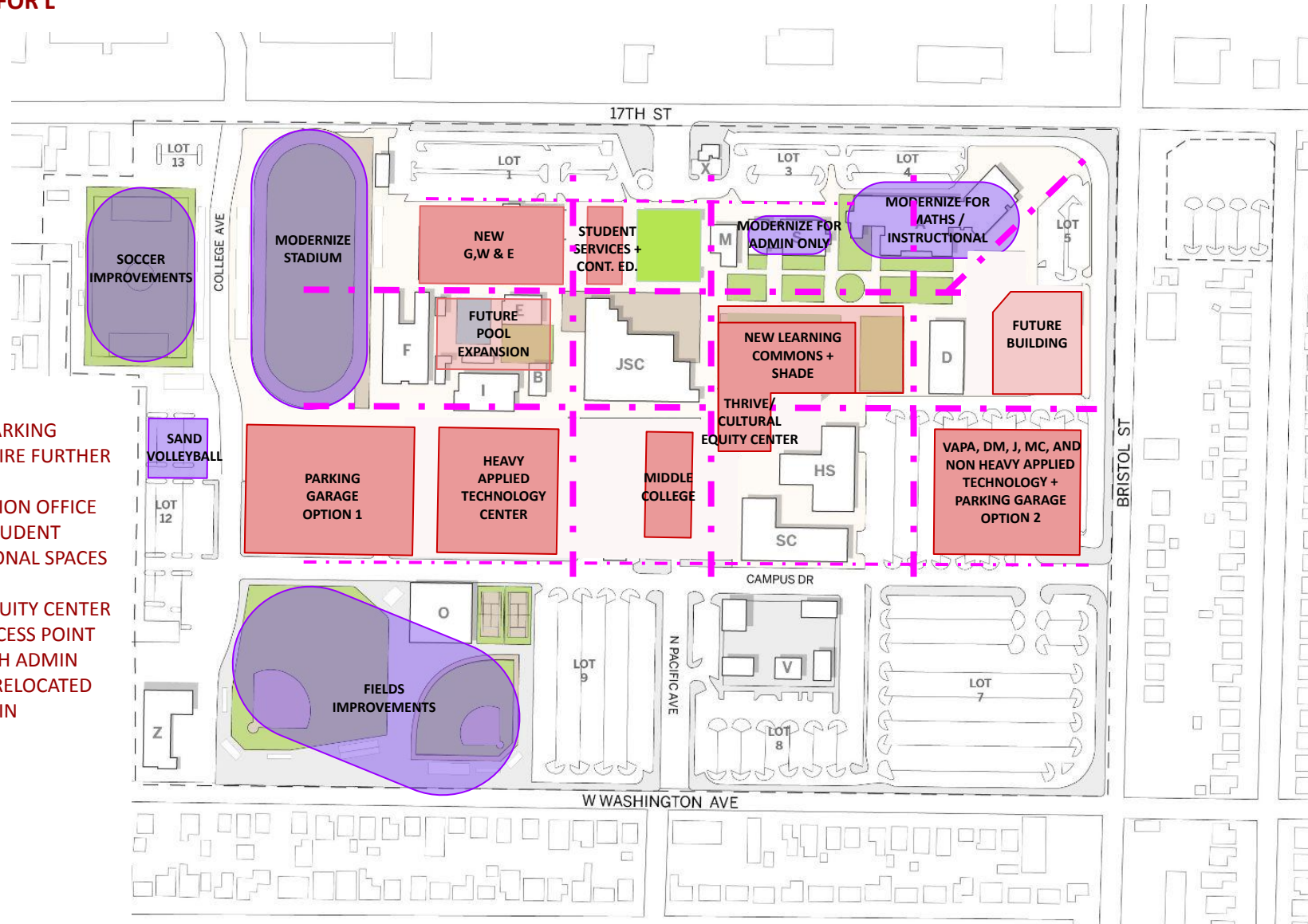

WE ARE HERE
Reviewing Preferred
Solutions and Projects
Prioritization

SAC Preferred Solution (Option 2)

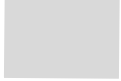
WILL REQUIRE SWING FOR L



LEGEND

-  Building Sites once Demolition occurs
-  Area targeted for Entrance/ Drop-off
-  Possible Pedestrian Pathways
-  New Buildings
-  Modernizations
-  Future Buildings

CLARIFICATIONS:

- TWO OPTIONS FOR PARKING GARAGES, WILL REQUIRE FURTHER STUDY
- CONTINUING EDUCATION OFFICE COLLOCATED WITH STUDENT SERVICES, INSTRUCTIONAL SPACES TO BE DETERMINED
- THRIVE/CULTURAL EQUITY CENTER TO HAVE ITS OWN ACCESS POINT
- CAMPUS SAFETY WITH ADMIN
- VILLAGE PROGRAMS RELOCATED APPROPRIATELY WITHIN BUILDINGS SHOWN

TO BE DETERMINED:

- DRONE PROGRAM
- DMC

UNDER SEPARATE STUDY:

- CEC
- 17TH/BRISTOL
- STUDENT HOUSING

Other Campus Locations Solutions / Updates:

**ORANGE COUNTY SHERIFF'S
REGIONAL TRAINING ACADEMY**
Feasibility Studies underway, and Preferred
Solution depicted here

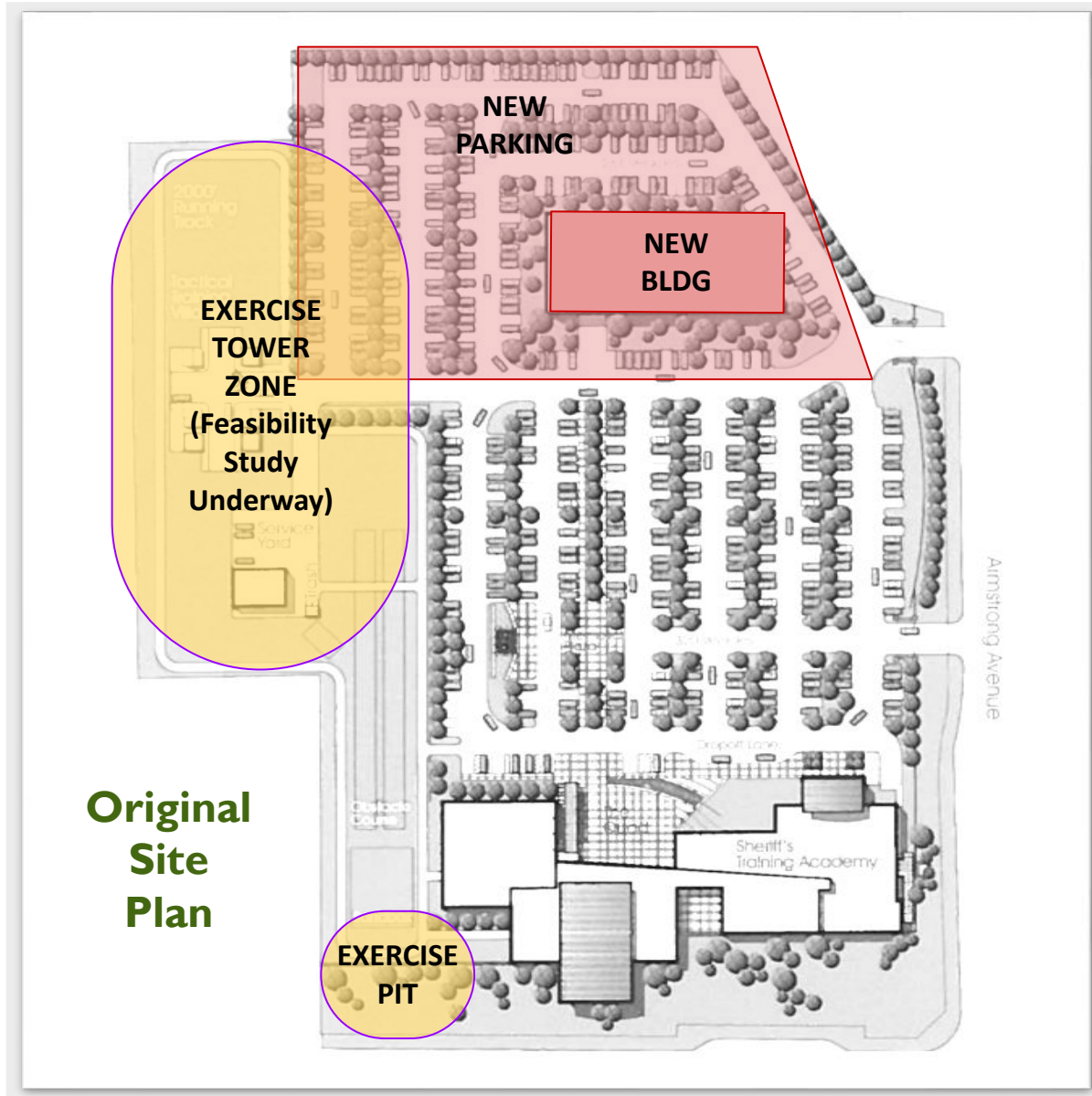

Other Campus Locations Solutions / Updates:

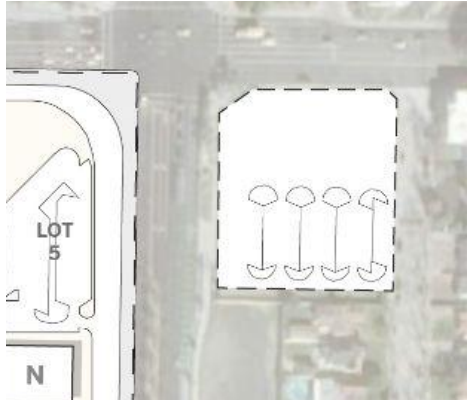

17TH / BRISTOL:

Feasibility Study underway by SVA Architects / The Concord Group

DIGITAL MEDIA CENTER (DMC):

As an outcome of this FMP Update process (proposed relocation of existing programs to SAC leaving facility vacant), a feasibility study for best use will be conducted

STUDENT HOUSING AT SAC/SCC:

Feasibility Study awaiting State Grant Funding

Prioritization, Process Status

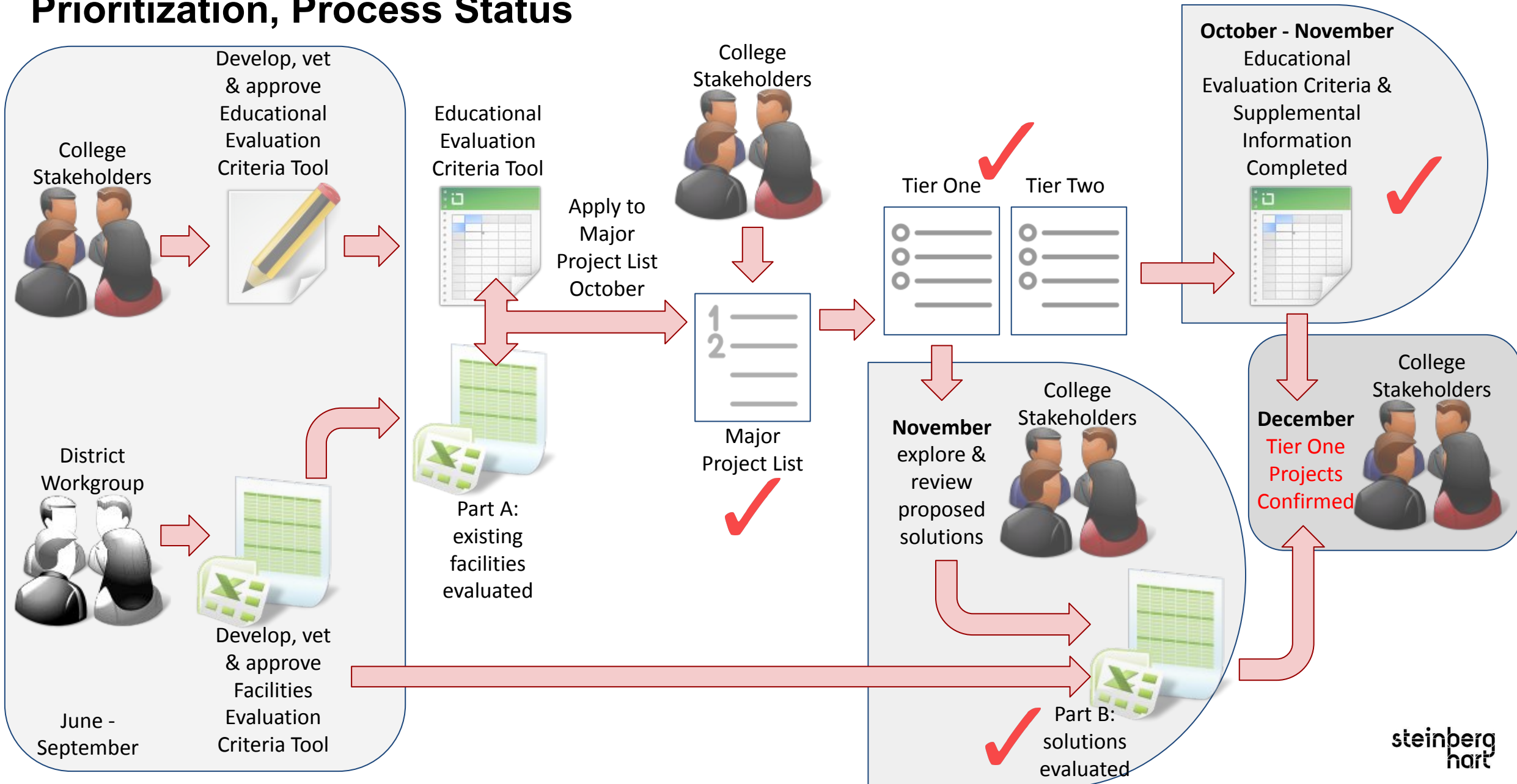

Prioritization, Supplemental Information Received:

Evaluation Category	Existing Location	Students to Include	Unduplicated Headcount								Supplemental Information				
			2014-15	2015-16	2016-17	2017-18	2018-19	2014 - 2019 Annual Trend	2019-20	2020-21	2020-21 Pell Grant Recipients (Unduplicated Headcount)	2020-21 California Promise Grant Recipients (Unduplicated Headcount)	Student Headcount, Completed a Degree/Certificate in 2018-2019	Student Headcount, Transferred in 2018-2019	Is there a Waiting List/Demand for course offerings? Fall 2019
PERFORMING ARTS VISUAL ARTS	PHILLIPS HALL, MUSIC BUILDING AND ART-C BUILDING, DMC	ART (Art) Students	2653	2689	2879	2824	3074		3000	2431	739	1547	1146	628	146
PERFORMING ARTS VISUAL ARTS	PHILLIPS HALL, MUSIC BUILDING AND ART-C BUILDING, DMC	CMSD (Communications & Media Studies)	143	145	271	355	342		342	326	108	214	145	77	14
PERFORMING ARTS VISUAL ARTS	PHILLIPS HALL, MUSIC BUILDING AND ART-C BUILDING, DMC	CMST (Communications Studies) Students	3526	3665	3668	3485	3561		3598	3201	1086	2181	1895	887	270
PERFORMING ARTS VISUAL ARTS	PHILLIPS HALL, MUSIC BUILDING AND ART-C BUILDING, DMC	DNCE (Dance) Students	575	593	585	542	654		489	269	108	210	267	131	4
PERFORMING ARTS VISUAL ARTS	PHILLIPS HALL, MUSIC BUILDING AND ART-C BUILDING, DMC	IDS (Interdisciplinary Studies) Students	628	503	439	274	147		143	129	40	89	146	97	0
PERFORMING ARTS VISUAL ARTS	PHILLIPS HALL, MUSIC BUILDING AND ART-C BUILDING, DMC	MUS (Music) Students	1710	1585	1457	1701	1706		1668	1354	367	773	656	347	52
PERFORMING ARTS VISUAL ARTS	PHILLIPS HALL, MUSIC BUILDING AND ART-C BUILDING, DMC	PHOT (Photography) Students	322	503	555	508	548		390	345	120	245	220	113	31
PERFORMING ARTS VISUAL ARTS	PHILLIPS HALL, MUSIC BUILDING AND ART-C BUILDING, DMC	TELV (Television) Students	1000	726	720	756	660		686	149	37	93	387	237	28
PERFORMING ARTS VISUAL ARTS	PHILLIPS HALL, MUSIC BUILDING AND ART-C BUILDING, DMC	THEA (Theater Arts) Students	437	559	539	471	583		814	476	131	245	267	154	1
MATH	MATHS CONSOLIDATION (HAMMOND HALL REPL)	MATH (Mathematics) Students	7742	7918	8222	8339	8158		7307	5905	1780	3751	2202	1263	432
LEARNING COMMONS: LIBRARY TUTORING - ALL LOCATIONS L, D AND A	NEALLEY LIBRARY L BUILDING, A BUILDING, D BUILDING	All Credit Students	47443	46930	43751	44159	45499		39862	29555	4682	12023	3691	1856	4903
"HEAVY DUTY" APPLIED TECHNOLOGY PROGRAMS: AUTO, DIESEL, WELDING,	BUILDINGS AUTO DIESEL-J, WELDING DIESEL-K AND TECHNICAL BUILDING T	AUTO (Automotive) Students	422	404	391	398	398		441	276	82	187	111	15	135
"HEAVY DUTY" APPLIED TECHNOLOGY PROGRAMS: AUTO, DIESEL, WELDING,	BUILDINGS AUTO DIESEL-J, WELDING DIESEL-K AND TECHNICAL BUILDING T	DSL (Diesel) Students	110	105	116	93	67		61	41	8	20	27	0	2
"HEAVY DUTY" APPLIED TECHNOLOGY PROGRAMS: AUTO, DIESEL, WELDING,	BUILDINGS AUTO DIESEL-J, WELDING DIESEL-K AND TECHNICAL BUILDING T	MNFG (Manufacturing Technology) Students	449	371	362	327	322		325	230	49	109	108	6	51
"HEAVY DUTY" APPLIED TECHNOLOGY PROGRAMS: AUTO, DIESEL, WELDING,	BUILDINGS AUTO DIESEL-J, WELDING DIESEL-K AND TECHNICAL BUILDING T	WELD (Welding) Students	295	327	344	288	163		242	135	28	64	77	9	32
"NON HEAVY DUTY" APPLIED TECHNOLOGY PROGRAMS: FASHION,	TECHNICAL BUILDING T; A BUILDING	CULN (Culinary Arts) Students	21	44	53	51	61		100	149	29	61	22	4	0
"NON HEAVY DUTY" APPLIED TECHNOLOGY PROGRAMS: FASHION,	TECHNICAL BUILDING T; A BUILDING	FDM (Fashion Design Merchandising) Students	235	197	222	237	248		256	251	51	127	62	23	26
"NON HEAVY DUTY" APPLIED TECHNOLOGY PROGRAMS: FASHION,	TECHNICAL BUILDING T; A BUILDING	FTC (Fire Technology) Students	881	864	833	872	946		1003	935	137	363	436	67	240
"NON HEAVY DUTY" APPLIED TECHNOLOGY PROGRAMS: FASHION,	TECHNICAL BUILDING T; A BUILDING	NUTR (Nutrition) Students	479	678	702	663	607		652	681	200	425	293	147	16
MIDDLE COLLEGE HIGH SCHOOL	PORTABLES B	All Middle College Students	329	332	330	330	325		299	292	n/a	n/a	223	40	n/a
ALL NONCREDIT STUDENTS	All Noncredit Sites	All Noncredit Students	22356	22619	22681	21389	18479		20003	19757	n/a	n/a	1239	219	n/a
NONCREDIT STUDENTS (CEC/OFF)	CEC & Other Off Sites (excluding SAC)	Noncredit Students	20283	19638	19024	18686	15966		17483	19757	n/a	n/a	228	57	n/a
NONCREDIT STUDENTS (SAC)	Noncredit Students at SAC	Noncredit Students	2788	3876	4728	3911	3305		3410	8	n/a	n/a	303	171	n/a
THRIVE CENTER / CULTURAL & EQUITY CENTER	THE VILLAGE all low income CREDIT students	All Low Income Students	15842	15704	15489	15344	15113		14543	12054	4643	12023	2611	1318	n/a
Criminal Justice, Criminal Justice Academy, Fire Technology and Fire Academy	OCSRTA, A BUILDING	All CJ (Criminal Justice) Students	1718	1409	1359	1331	1086		1071	856	295	575	405	219	17
Criminal Justice, Criminal Justice Academy, Fire Technology and Fire Academy	OCSRTA, A BUILDING	All CIA (Criminal Justice Academy) Students	15893	15929	14907	14072	14607		10650	5559	13	31	35	23	1
Criminal Justice, Criminal Justice Academy, Fire Technology and Fire Academy	OCSRTA, A BUILDING	All FAC (Fire Academy) Students	2896	2921	2572	2247	3424		1689	1122	30	108	305	43	0
Criminal Justice, Criminal Justice Academy, Fire Technology and Fire Academy	OCSRTA, A BUILDING	All FOT (Fire Officer Training) Students	526	465	353	131	98		65	44	2	8	104	10	0
Criminal Justice, Criminal Justice Academy, Fire Technology and Fire Academy	OCSRTA, A BUILDING	All FSA (Fire Public Safety) Students	4120	3495	1224	2470	2087		1818	0	0	0	33	11	0
Criminal Justice, Criminal Justice Academy, Fire Technology and Fire Academy	OCSRTA, A BUILDING	All FTC (Fire Technology) Students	881	864	833	872	946		1003	935	137	363	436	67	240

Source: Research Data Warehouse, National Student Clearinghouse, Online Report Repository (RG0541)

Prioritization, Bear in Mind

Tier One Projects:

- Projects listed under Tier One for each campus encompass the highest scoring projects based on Educational and Facilities Solutions Evaluation Criteria. However, the order that they appear does not reflect the sequence that the projects will be executed. Sequencing will depend on implementation & swing logistics, as well as funding opportunities.
- Naming of Projects may be refined further to be abbreviated etc. FMP Update narrative will describe what programs those projects are expected to address.

Tier Two Projects

- The order they appear does not reflect priority order.
- Projects & Solutions (where applicable) will be identified and part of the FMP Update. However, these projects will not be part of the implementation studies, which will cover the Tier One projects only.

Prioritization, SAC Preferred Solution - Tier One

SAC 2021 FMP UPDATE PROPOSED SOLUTIONS			COMMENTS
PROPOSED SOLUTION	ABBREVIATED LABEL	PROJECT NEEDS	
NEW (HEAVY DUTY ONLY) APPLIED TECHNOLOGY BUILDING AND PARKING GARAGE	NEW ATC OR CTE COMPLEX?	"HEAVY DUTY" APPLIED TECHNOLOGY PROGRAMS: AUTO, DIESEL, WELDING, MANUFACTURING TECHNOLOGY PARKING/TRAFFIC CIRCULATION IMPROVEMENTS	THE VILLAGE WILL NEED TO SWING
NEW VISUAL ARTS, PERFORMING ARTS, MEDIAARTS, CULINARY & FASHION (VAPAMACF) BUILDING AND PARKING GARAGE	NEW WORKFORCE DEVELOPMENT COMPLEX?	PERFORMING ARTS, VISUAL ARTS, DIGITAL MEDIA, JOURNALISM, COMMUNICATIONS "NON HEAVY DUTY" APPLIED TECHNOLOGY PROGRAMS: FASHION, NUTRITION/CULINARY, FIRE TECHNOLOGY	
NEW LEARNING COMMONS (INCLUDES THRIVE / CULTURAL & EQUITY CENTER)	NEW LEARNING COMMONS	LEARNING COMMONS (LIBRARY, TUTORING & INSTRUCTIONAL SUPPORT CENTER) THRIVE CENTER / CULTURAL & EQUITY CENTER	PREFERRED OPTION REQUIRES EXISTING L BUILDING OCCUPANTS TO SWING
NEW REPLACEMENT CENTENNIAL EDUCATION CENTER (SEE SEPARATE MASTER PLAN STUDY)	NEW CEC	CEC	
MODERNIZE BUILDING A (CESAR CHAVEZ) TO COLLOCATE MATHS & INSTRUCTIONAL USE	BUILDING A MODERNIZATION	MATHS CONSOLIDATION (HAMMOND HALL REPLACEMENT) OPTIMIZE BUILDING A	MIGHT REQUIRE SWING UNLESS PHASED
NEW WELCOME CENTER FOR STUDENT SERVICES	NEW WELCOME CENTER	OPTIMIZE S BUILDING	NEEDS TO OCCUR AFTER BUILDING A MODERNIZATION

Prioritization, SAC Preferred Solution - Tier Two

SAC 2021 FMP UPDATE PROPOSED SOLUTIONS			COMMENTS
PROPOSED SOLUTION	ABBREVIATED LABEL	PROJECT NEEDS	
NEW REPLACEMENT ATHLETIC GYM FACILITIES (REPLACES G/E/W)		BUILDING G, G PAVILION, W AND E DEFICIENCIES	HARD TO SCORE DUE TO LACK OF CLARITY
MODERNIZE BUILDING S FOR ADMINISTRATION, CEWD AND CAMPUS SECURITY		OPTIMIZE S BUILDING	WILL REQUIRE SWING
		CAMPUS SAFETY/SECURITY FACILITY	
NEW REPLACEMENT MIDDLE COLLEGE HIGH SCHOOL		MIDDLE COLLEGE HIGH SCHOOL	
STADIUM MODERNIZATION		COMPLETE STADIUM FOR COLLEGE USE (INCOMPLETE)	WILL REQUIRE SWING
OCSRTA EXERCISE PIT AND TOWER (feasibility study underway)		OCSRTA FIRE TECHNOLOGY & CRIMINAL JUSTICE	
CAMPUS IMPROVEMENTS PROJECT PHASE 2 AND 3		POST RUSSELL HALL DEMOLITION SECONDARY EFFECTS	HARD TO SCORE DUE TO LACK OF CLARITY
OCSRTA NEW PUBLIC SAFETY FACILITY		OCSRTA FIRE TECHNOLOGY & CRIMINAL JUSTICE	
NEW DRONE EXTERIOR FACILITY REQUIRES SEPARATE STUDY TO DETERMINE LOCATION		DRONE PROGRAM	
BASEBALL AND SOFTBALL FIELDS		BASEBALL AND SOFTBALL FIELD IMPROVEMENTS	HARD TO APPLY EDUCATIONAL EVALUATION CRITERIA
OUTDOOR AMPHITHEATER UPGRADES (@ DUNLAP HALL)		SHADE AMPHITHEATER AND OTHER CAMPUS SPACES	HARD TO APPLY EDUCATIONAL EVALUATION CRITERIA
SHADE STRUCTURES AND PLAZA DE ARTES		SHADE AMPHITHEATER AND OTHER CAMPUS SPACES	HARD TO APPLY EDUCATIONAL EVALUATION CRITERIA
NEW (2) SAND VOLLEYBALL COURTS		SAND VOLLEYBALL	HARD TO APPLY EDUCATIONAL EVALUATION CRITERIA
SOCCER FIELD IMPROVEMENTS		SOCCER FIELD IMPROVEMENTS	HARD TO APPLY EDUCATIONAL EVALUATION CRITERIA
NEW REPLACEMENT ENLARGED POOL		POOL	HARD TO APPLY EDUCATIONAL EVALUATION CRITERIA
STUDENT HOUSING SEPARATE STUDY - SEE BELOW		STUDENT HOUSING	HARD TO SCORE DUE TO LACK OF CLARITY
NEW 17TH/BRISTOL PROJECT TO BE DEFINED BY SEPARATE STUDY UNDERWAY		OPTIMIZE USE OF 17TH/BRISTOL SITE	HARD TO SCORE DUE TO LACK OF CLARITY
REPURPOSE DMC TO BE DETERMINED BY SEPARATE STUDY		OPTIMIZE DMC SITE	HARD TO SCORE DUE TO LACK OF CLARITY
IN PROJECTS ABOVE		VILLAGE REPLACEMENT	

Some Possible Sequencing Scenarios for SAC Campus Projects

Final Scenario will depend on available funding resources and implementation/swing logistics

Scenario One

New Workforce Development
(with Parking Garage)

*Learning Commons Swing (in C,
N and P)*

New Learning Commons

New Applied Technology Center
(possibly with Parking Garage)

Modernize Building A

New Welcome Center

Scenario Two

Village Swing

New Applied Technology Center
(with Parking Garage)

New Workforce Development
(possibly with Parking Garage)

*Learning Commons Swing (in C,
N and P)*

New Learning Commons

Modernize Building A

New Welcome Center

Scenario Three

Learning Commons Swing (tbd)

New Learning Commons

New Applied Technology Center
(with Parking Garage)

New Workforce Development
(possibly with Parking Garage)

Modernize Building A

New Welcome Center

Next Steps

- Refinement of Project Names (now through February 2022)
- Explore Implementation and Sequencing Scenarios
- Create Conceptual Cost Estimates for Tier One Projects
- Creation of Draft FMP Update Document (December - January)
- Review of Draft FMP Update Document in February 2022
- Community Campus Forums on Draft FMP Update (TBD)
- Finalize FMP Update